

Ste. Genevieve

County

Tombstone Inscriptions

Vol. 1

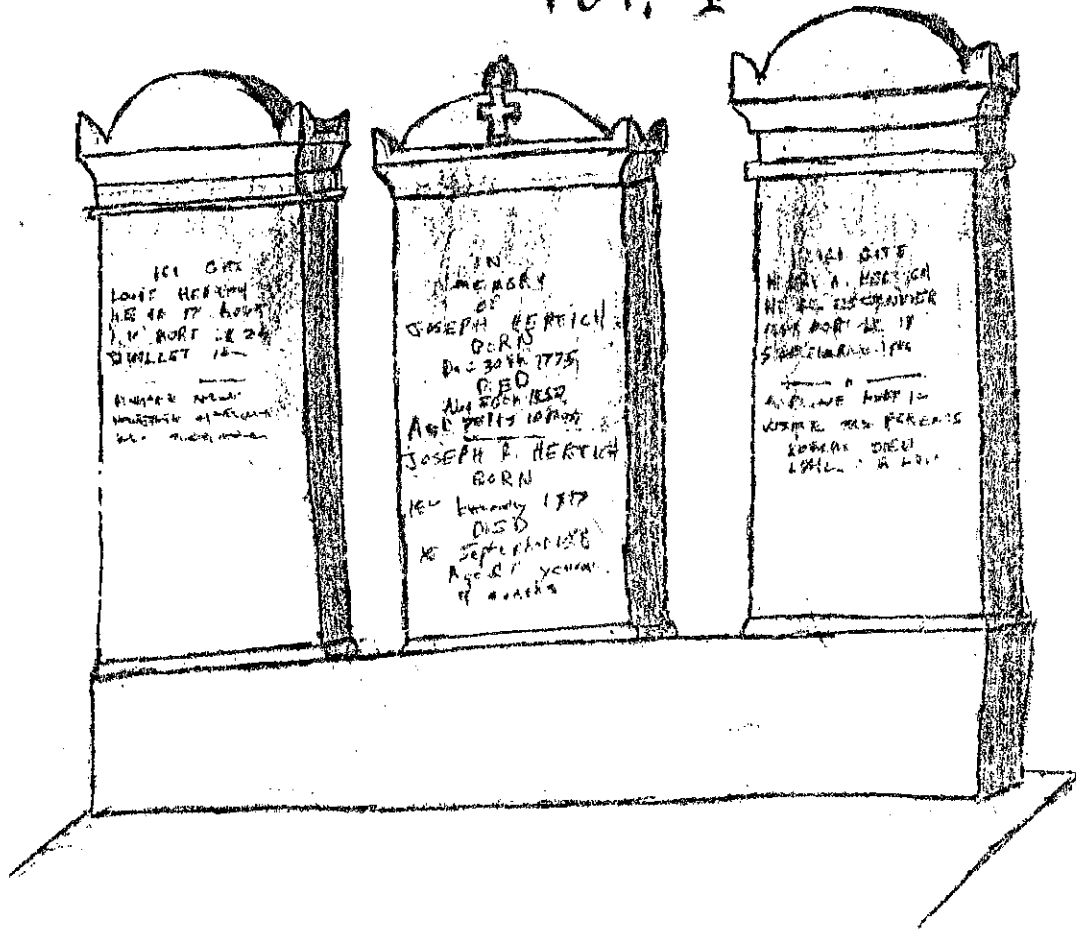

STE. GENEVIEVE COUNTY
TOMBSTONE INSCRIPTIONS
Volume 1

compiled by Rob Beckerman

completed-June 18, 1982

dedicated to
André DeGuire LaRose
founder of Ste. Genevieve

Copyright © 1982 Rob Beckerman
WARNING-The reproduction of any part of this book
without the prior written consent of Rob
Beckerman is prohibited by U.S. Copyright
Law and is subject penalty.

OZARK REGIONAL LIBRARY
360 MARKET ST.
STE. GENEVIEVE, MO 63670

INTRODUCTION

It has been our attempt in compiling this book to record as accurately as possible the tombstone inscriptions in four of the burial sites in Ste. Genevieve, Missouri. Many mistakes which will seem to have been made by the typist are actually the way the inscription appeared on the stone.

The stones have been numbered in each cemetery in the order in which the information was collected. An alphabetical listing can be found at the back of the book. These numbers are also used on the maps which accompany each cemetery's listings.

A single dash, as in #45 on page 2, indicates a space on the stone which has yet to be inscribed. A series of dashes indicates an inscription which has weathered too badly to be read. Information appearing in parentheses usually indicates information which did not appear on the stone, but is necessary to identify the name on the stone.

TABLE OF CONTENTS

Cemetery Listings	Index	37
City Cemetery	1 Maps	
Lutheran Cemetery	14	City Cemetery 13a
Memorial Cemetery	18	General (with all
Ste. Genevieve Catholic		cemeteries) 13c
Church	33	Lutheran Cemetery 17
Glossary & Translations	35	Memorial Cemetery 32
		Ste. Genevieve Catholic
		Church 34

1. Harold H. Brown
June 5, 1930–Oct 5, 1965
In loving memory wife and children
2. Lloyd J. Cheatam
Illinois
CIL U.S. Army
Korea
March 23, 1931–March 11, 1963
3. PARMER
Elmer L. Mamie P.
Oct 4, 1908 Aug 24, 1911
Jan 8, 1964
4. JOHNSON
Gussie C. Harriet E.
Mar 25, 1918 May 13, 1925
Sept 20, 1965
5. Infant daughter of John & Norma Howard
born & died–July 2, 1934
6. Clyde James Howard
Nov 19, 1917–June 6, 1935
7. Albert J. Howard
Nov 2, 1924–Dec 24, 1933
8. Henry C. Sadler
Jan 10, 1889–Oct 26, 1962
9. Ada M. Sadler
Apr 27, 1895–Nov 30, 1932
10. Earl B. Williams
Apr 22, 1914–Mar 28, 1936
11. Thomas E. Tucker
born & died–Mar 28, 1961
12. Rosa Ann Brown
Mar 20, 1872–Jan 17, 1952
13. John W. Brown
Nov 1, 1868–Apr 2, 1942
14. Melvin R. Schaaf
Sept 2, 1915–Nov 17, 1932
15. LOIDA
Harry J. Rachel C.
1902– 1903–1964
16. NICKELSON
Marie Rastus
May 31, 1904 Feb 8, 1901
Dec 21, 1975 Nov 10, 1956
17. Mother
Ellen Nickelson
Mar 23, 1878–Oct 9, 1951
18. McKLIN
Rachel John
Mar 13, 1879 Aug 20, 1879
Oct 3, 1946 Jan 11, 1947
19. Elizabeth Pelate
1866–1937
- +20. VICKERS
+ Julia Henry J.
+ Jan 1, 1883 Nov 14, 1869
+ July 7, 1945
- +21. Louise Hannah Campbell
+ Nov 7, 1865–Apr 28, 1944
- +22. William E. Campbell
+ Sept 18, 1892–Mar 10, 1936
- +23. Arthur Earl Martin
+ Mar 10, 1940–Nov 18, 1940
- +24. William L. Martin
+ Nov 16, 1896–June 7, 1936
- +25. Clyde T. Albright
+ Missonri
+ PFC Coast Arty
+ World War II
+ July 17, 1904–July 7, 1970
- +26. Annie L. Albright
+ July 3, 1916
+ -
- +27. Martha C. Williams
+ Sept 22, 1889–June 7, 1962
- +28. Hazel W. Reber
+ Aug 6, 1890–May 14, 1962
- +29. Mary E. Brown
+ born–Nov 10, 1824
+ died–Mar 10, 1906
+ I have found the shore of everlasting life.
- +30. Josie beloved wife of
+ Lewis B. Brown
+ born–Jan 8, 1867
+ died–July 9, 1904
+ aged–37 yrs., 6 mo., 1 d.
+ Remember as you pass by,
+ as you are so once was I
+ As I am soon you will be.
- +31. Bessie infant dau of L. & J. Brown
- +32. Louise Brown
+ born–Nov 4, 1893
+ died–Dec 1, 1918
+ Gone to a bright home,
+ where grief can not come.
- +33. Gussie C. Johnson
+ Illinois
+ CPL 12 Bomb GP AAF
+ World War II
+ March 25, 1981–Sept 20, 1965
- +34. SCAGGS
+ Lester R. -
+ 1909–1952 -
+
+

35. PIRTLE
 Effie Neal C.
 Oct26,1884 Mar19,1867
 Mar4,1953 July8,1947
36. ADAMS
 George J. Ruby E.
 1901-1977 1900-1959
37. HOWARD
 In loving memory
 John W. Norma L.
 July30,1888 Oct30,1890
 Apr29,1975 Mar12,1976
38. Mary L. Schaaf
 Nov26,1892-May28,1978
39. Nicholas Joseph Schaaf
 son of Dennis W. & Judy A.
 born&died-January8,1980
40. Chris Nickelson
 Dec25,1910-Aug14,1979
41. Chas. H. Hall
 1851-1932
42. LUNSFORD
 Grace Noah
 1890-19 1876-1945
43. Richard E. Byrd
 1932-1932
44. MARTIN
 Chris C. Laura M.
 May30,1895 June14,1897
 Oct11,1972
45. MARTIN
 Carl C. Lillian L.
 Sept16,1919 Aug12,1922
46. WHITESIDE
 Father Mother
 Alvis R. Hazel L.
 Oct30,1895 Sept8,1897
 Nov3,1978 Feb16,1978
47. WHITESIDE
 R.Eugene Grace E.
 Jan10,1917 Apr14,1924
 Jun1,1957
48. Alice E. Chadwell
 born-Aug30,1881
 died-Sep25,1884
49. Alice M. wife of A.H. Chadwell
 born-July12,1840
 died-Feb22,1902
50. Genevieve Pratte
 1868-1950
51. Alexander H. Chadwell
 born-Feb16,1838 died-June7,1912
- +52. Mary L. Lankford
 + Jan9,1877-June25,1950-
- +53. Clarence E. Pelate
 + 1907-1947
- +54. Armella L. Petersen
 + Oct18,1907-Jan15,1981
- +55. PETERSEN
 + Henry C. Hedwig I.
 + Aug21,1871 July24,1879
 + Feb8,1955 May8,1942
- +56. ACUFF
 + Patrick H. Flora V.
 + Dec22,1875 Aug1,1881
 + Mar2,1965 Jun29,1957
- +57. FEENEY
 + Samuel Maggie
 + 1891-1957 1893-
- +58. Chris Nickelson
 + CPL U.S. Army
 + World War II
 + Dec25,1910-Aug14,1979
- +59. FEENEY
 + Oscar S. Evelyn E.
 + Apr3,1914 Oct21,1920
 + May1,1963
- +60. Ralph A. Grannemann
 + 1901-1963
- +61. Bessie L. Grannemann
 + 1882-1967
- +62. ROBERTSON
 + Nicholas J. Ethel C.
 + Jan1,1889 Jan11,1888
 + Aug11,1974
- +63. Ruth V. Robertson
 + Dec16,1910-July17,1930
- +64. Joseph E. Beasley
 + Missouri
 + PFC 753 AAA Gun BN CAC
 + World War II
 + Feb3,1930-Apr11,1950
- +65. BEASLEY
 + Emma L. John H.
 + July19,1890 Nov22,1879
 + Dec22,1956 Mar5,1964
- +66. GRIFFARD
 + George W. Lillian
 + Sept22,1884 Feb24,1885
 + May11,1977 Dec31,1965
- +67. Roy Eugene Whiteside
 + Missouri
 + SGT Infantry
 + World War II BSM
 + Jan10,1917-June1,1957

68. SCOTT
William D. Dellavan C.
June3,1934 May1,1940
Dec30,1957
69. Charles P. Penberthy
May1,1947-Sept21,1965
70. McCARRON
Paul J. Avis V.
Sept13,1909 Oct18,1909
Mar26,1971
71. Anton Hunold
1852-1930
72. Minnie B. Parmer
Aug16,1880-July23,1941
73. John Parmer
Mar1,1882-Dec9,1944
74. Roudolph A. Seufert
Sept25,1904-Dec31,1942
75. Hugh E. Wood
1883-1942
76. Charles M. Taylor
1882-1972
77. John Knobel
May17,1865-Aug25,1943
78. MILLER
Jessie Addie
1892-1953 1918-1946
79. CULLEY
James Euletia
1875-1946 1882-19
80. William Lux
1879-1947
81. Evelyn Sue Deramus
May10,1947-Feb19,1948
82. LALUMONDIERE
Harry Catherine
nee Trautman
Nov5,1879 Sept4,1885
July4,1948 Apr4,1949
83. George LaBruyere
1880-1948
84. James G. Chalmers
Jan26,1872-Nov25,1950
85. Ollie D. Lampman
Nov8,1872-Nov26,1951
86. Claude R. Patterson
born-August13,1899
died-March19,1952
87. KEMP
Minnie I. Andrew J.
1894-1971 1882-1952
88. Barbara Harter
- +89. WATSON
+ James W. Mary M.
+ Sept10,1898 Mar3,1920
+ Dec29,1965
- +90. Evaora dau of
+ John & Anna Cheesebrough
+ died-Dec9,1902
+ aged-1year
- +91. Gerald E. Marlen
+ Jan8,1931-Feb13,1941
- +92. MARLEN
+ Thomas M. Olive Mary
+ Mar21,1892 July14,1915
+ Aug5,1974
+ Jesus said: Whosoever liveth and
+ believeth in me shall never die.
- +93. MARLEN
+ Lawrence S. Nellie Viola
+ Apr5,1867 July22,1871
+ Dec31,1944 Aug18,1941
+ Phil 1:23: "To depart and to be
+ with Christ which is far better."
- +94. MARLEN
+ Harry B. Roy W.
+ May22,1889 Mar16,1896
+ Sept28,1962 Feb21,1964
+ May the Lord watch between me and
+ thee when we are absent one from
+ another.
- +95. Archie B. Henson
+ Mar24,1907-Feb19,1943
- +96. Robert Northcutt
+ Sept8,1873-Dec26,1949
- +97. Elizabeth A. Northcutt
+ Nov8,1876-Sept9,1942
- +98. WALLACE
+ James A., Jr. Velma F.
+ Jan18,1912 Nov29,1917
+ Aug16,1962
- +99. JAMES
+ Eugene V. Beulah H.
+ 1908- 1917-1958
+ He is our peace.
- +100. WILLIAMS
+ Elmer Naomi
+ May29,1915 Aug12,1917
+ Dec1,1962
- +101. Bessie Bruidgre
+ Mar22,1885-July1,1966
- +102. MILLER
+ C. Leonard Lois L.
+ July3,1904 Mar13,1905
+ Jan10,1971

103. BRINKMAN
Ivan Paul Margaret Jane
Aug5,1920 July8,1937
Nov4,1976
104. SEGUIN
C. Edward Myrtle M.
June10,1905 June13,1907
105. STANGE
106. John E. Samples
Jan1,1888-May28,1975
107. Beulah E. Samples
Sept25,1897-Oct26,1968
108. STEAGALL
Herman T. Delia Mae
Oct11,1898 Jan28,1902
Jan27,1970 June16,1964
109. William Delain Scott
Missouri
AM 3 U.S. Navy
June3,1934-Dec30,1957
110. SCHNURR
Reath R. Charles H.
1897- 1892-1967
111. Wm. Joggerst
born-May15,1854
died-Oct18,1913
112. GISI
Rosaliee Joseph J.
Sept2,1858 Jan24,1857
Oct17,1916 June2,1931
Their toils are past. Their work is
done.
They fought the fight. The victory
won.
113. John W. Shaw
June25,1851-Dec6,1916
114. Dorris D. Bond
1902-1920
115. Dora E. Bond
1874-1961
116. Charles T. Bond
1869-1925
117. Chester A. Feverston
1898-1954
118. Eva Feverston
1881-1956
119. Howard W. Gross, Jr.
1942-1954
120. Albert "Butch" Cook
1890-1954
121. E.M. McGary
1885-1954
- +122. Harry Beyatte
+ Missouri
+ PVT BTRY A 124 FIELD ARTY
+ World War I
+ Nov2,1889-Aug1955
- +123. Joseph James
+ CPL CO H 6 REGT MO INF
+ Spanish-American War
+ Mar16,1876-Dec14,1957
- +124. Jesse B. Miller
+ Mar4,1896-Sept18,1973
- +125. FARLOW
+ Thomas W. Luella
+ Dec17,1882 Apr20,1888
+ Nov28,1958 Dec18,1968
- +126. LONG
+ Valda A. Edward G.
+ Apr11,1899 May13,1893
+ July12,1981 Jan28,1959
- +127. Jessie J. Wood
+ 1892-1959
- +128. Harry A. Hutson, Sr.
+ Missouri
+ BM2 USNR
+ World War I & II
+ Jan17,1901-Aug4,1959
- +129. LaLUMONDIERE
+ Harold J. Mary Elzene
+ Sept27,1918 Mar30,1923
+ Mar28,1965
- +130. William G. McCarthy
+ Missouri
+ PVT 3 CO 164 DEPOT BRIGADE
+ World War I
+ Oct6,1894-April26,1965
- +131. Willie B. son of
+ ----- & Caroline James
+ born-July8,1889
+ died-July7,1903
- +132. our darling
+ Bobby Shoults
+ July15,1950
- +133. John Walker
+ June15,1892-Nov14,1951
+ Peace I leave with you.
+ My peace I give unto you.
- +134. Frances Jo Walker
+ Sept5,1926-June22,1943
+ May the Lord watch between me and
+ thee while we are absent, one from
+ another.
+
+

135. Nann Louise
wife of John H. Walker
He giveth his beloved sleep.
136. CLAPSADDLE
Clare J., M.D. Hazel
Apr26,1890 Jan29,1894
Mar14,1959 May18,1975
137. SMITH
Helen R. Ralph W.
Apr28,1898 Oct12,1891
Apr6,1961 Mar22,1976
1 John 4:16 "God is Love."
138. CABRAL
Christy G. Christine H.
Mar2,1903 Aug4,1903
Jan19,1962
139. STROMAN
Harold W. Myrtle
Oct5,1891 Sept8,1894
Dec21,1962 Oct2,1970
140. HUGHES
141. Lavada McDaniel
June10,1899-
142. WOOD
Evelyn C. Claude M.
1907-1970 1903-1959
143. WALLS
Clarence Susan
Aug3,1888 July21,1890
Feb11,1966 Jan16,1959
144. William R., Sr. (Stange)
1903-1966
145. Linda Lee Akins
born&died-Jan13,1941
146. Vergie L. (Stange)
1917-
147. TAYLOR
James Jane
1854-1927 1854-1930
148. Charles H. Schnurr
Missouri
PVT CO H 70 Infantry
World War I
Nov3,1892-Dec29,1967
149. VANDERHEYDEN
Theodore Elsie M.
Aug18,1904 Feb27,1904
Mar16,1981 Sept9,1969
150. Daniel Langeneckert
Sept16,1949-Mar26,1970
- + 151. MULLINS
+ Andrew W. Hilda H.
+ July5,1900 June21,1906
+ Aug7,1970
- + 152. Louis Jackson
+ of Cuba, MO
+ Sept6,1881-Apr11,1971
- + 153. STRETCH
+ Lester E. Mildred B.
+ Oct5,1921 July27,1925
+ Feb7,1972
- + 154. THOMAS
+ Jack Peggy
+ 1909- 1910-1972
- + 155. WALKER
+ Phillip H. Marie M.
+ Sept9,1914 June2,1913
+ Dec20,1972 June27,1978
- + 156. Percy E. Pelate
+ 1901-1972
- + 157. Jesse B. Miller
+ Indiana
+ PVT U.S. Army
+ World War I
+ March4,1896-Sept18,1973
- + 158. HARTER
+ Richard S. Olive M.
+ Sept7,1905 Nov5,1903
+ Jan25,1973
- + 159. KRUGER
+ Francis S. Eleanor
+ Aug17,1905 May13,1909
+ Feb5,1973
- + 160. Rick W. Stretch
+ Aug26,1954-Apr17,1973
- + 161. Morris Freeland
+ 1937-1973
- + 162. William G. McCarthy
+ 1894-1965
- + 163. Asleep in Jesus
+ MARTIN
+ Lloyd A. Larry P. Mary N.
+ Jan1,1903 May26,1948 Jan15,1907
+ Feb1,1979 July12,1968
- + 164. Kenneth E. Forbes
+ July21,1919-Jan5,1968
- + 165. HATHAWAY
+ Samuel R. Martha C.
+ Aug28,1922 Nov11,1922
+ Feb22,1969
+ Death doth hide, but not divide.
+ Thou art but on Christ's other
+ side.

165. (continued)
Thou art with Christ--
and Christ with me;
together still in Christ are we.
166. HATHAWAY
Reid Martha C.
Nov17,1897 Decl,1897
Apr28,1969
167. Scott A. Yarbrough
Apr21,1962
168. James Harley Rudloff
Nov16,1954-Nov17,1954
169. RUDLOFF
Leeman H. Ruth L.
Apr4,1920 Nov8,1922
Apr9,1967 Oct27,1973
170. SHOULTS
Harley C. Nellie L.
Mar6,1894 Apr10,1901
Feb19,1965 July23,1977
171. ROSE
Leonard M. Eula V.
Aug23,1901 Nov15,1907
Jun10,1969
172. F. Andrew Hughes
Decl15,1893-Aug15,1966
173. Stacy Ann Palmer
Oct22,1966
174. VINEYARD
Emmett Pluma
Feb22,1881 Nov19,1891
Apr10,1948 Dec31,1933
175. WINSTON
Lewis J. Susuanna N.
May8,1890 Jan1,1893
Jan9,1964 June7,1981
176. JACKSON
Horace G. Sallie
Aug27,1900 July15,1906
Dec23,1963 July20,1964
177. Mildred A. dau of D.W.&M.V. Anthony
died-Feb21,1901
aged---Mo.14Ds.
178. Delbert Ray
beloved son of J.E.&E. Seysler
born-May8,1890
died-Sep5,1900
aged-10yrs.,3mo.,28d.
At Rest
179. Mother
Emma S. Rigdon
born-Jan17,1867
died-Mar2,1956
- +180. Father
+ Francis A. Rigdon
+ born-June18,1864
+ died-Nov19,1923
- +181. ROTH
+ Frank R. Stella G. Linda Lee
+ Sept19,1880 Apr4,1887 Feb5,1930
+ May17,1964 Aug7,1960
- +182. MACKLIN
+ Martin F. Bertha B.
+ 1931- 1937-1973
- +183. HOLST
+ son mother son
+ Donald C. Lillie Mae J. Harrison
+ Dec29,1929 Oct28,1891 Mar22,1911
+ July11,1974 Aug20,1980 July1,1980
- +184. Charles D. Nugent
+ Illinois
+ PVT Infantry
+ World War I
+ Sept15,1897-July11,1970
- +185. MYERS
+ Ray J. Ethel J.
+ nee Mueller
+ Apr4,1896 Dec12,1897
+ Jan21,1975
- +186. Elsie Turner
+ 1913-1974
- +187. Monroe L. McMurty
+ Oct30,1926-Sept15,1955
+ husband and father of 8 daughters
- +188. Bennett Brothers
+ Oscar Herbert
+ Mar13,1893 Nov10,1892
+ Oct13,1975 Nov13,1976
- +189. RHINEHART
+ Milton R. Lena I.
+ Aug29,1905 June4,1905
+ July22,1976
+ at rest
- +190. Lester F. Stretch, Sr.
+ Missouri
+ TEC 4 929 ORD HAM CO
+ World War II
+ Oct5,1921-Feb7,1972
- +191. MACKLIN
+ Coy J. Louise
+ Nov8,1907 June6,1907
+ Aug8,1976
- +192. BARWIG
+ John H. Edna M.
+ Jan27,1912 Mar16,1909
+ Sept7,1977

193. William T. Schmidt
Dec25,1955-Oct15,1977
in loving memory of my son
194. Rosie Maxey Noakes
Mar22,1888-Nov2,1977
195. Charles McKlin
1905-1977
196. AGARAND
Joseph A., Sr. Frieda K.
Nov4,1906 Aug28,1913
Aug30,1978
197. David S. Gordon
1967-1978
198. Mamie E. Samples
Apr26,1890-Aug23,1976
199. SAMPLES
Jessie James
Oct28,1866 Aug27,1860
Nov1,1953 Mar31,1912
200. Virginia Pearl Samples
born-Aug6,1912
died-Oct3,1912
201. Father
Andrew Miller
born-Sept18,1828
died-Sept8,1910
202. Samuel R. Hathaway
Missouri
1st Lt 88 Infantry Div
World War II
Aug28,1922-Feb22,1969
203. KUHN
Tony A. Audrey M.
Aug6,1892 Dec6,1918
Dec14,1970 Mar21,1980
204. SCHLOSS
Archie Lee Dorothy Mae
Jan21,1901 Feb10,1904
July4,1979
205. Leeman H. Rudloff
Missouri
S1 USNR
World War II
Apr4,1920-April9,1967
206. SADLER
Alvin C. Beulah M.
Mar4,1902 Jun1,1903
June23,1981 Nov9,1970
207. Edgar A. Buckholtz
June10,1910-Oct31,1971
208. David Michael Hamper
Oct13,1967-Sept27,1972
- +209. LaROSE
+ Ernest M. Ruby E.
+ Aug4,1893 Dec1,1899
+ Sept27,1972
- +210. Rose L. Evans
+ July5,1909-Jan7,1959
- +211. LITTEREST
+ Theodore G. Marjorie A.
+ May30,1898 July15,1907
+ - -
- +212. Marilyn J. Litterest
+ Apr9,1928-Mar21,1931
- +213. in memory of
+ Sandy M. Sparkman
+ Dec25,1870-Aug26,1950
+ at rest
- +214. in memory of
+ Owen M. Sparkman
+ Feb10,1909-July4,1955
+ rest in peace
- +215. Louis J. Winston
+ Missouri
+ PFC CEN INF OFF TNG SCH
+ World War I
+ May8,1890-Jan9,1964
- +216. Horace G. Jackson
+ Missouri
+ PFC 1767 SVC COMD UNIT
+ World War II
+ Aug27,1900-Dec23,1963
- +217. RICKS
+ Virgil M. Agnes L.
+ Jan22,1896 June5,1904
+ May17,1971
- +218. SUMMERS
+ Russell E. Stella R.
+ Nov23,1926 May23,1930
+ Sept25,1969
+ The gift God gives is everlasting
+ life.
- +219. ROTH
+ Wilfred J. Stella
+ Nov8,1912 Nov9,1912
+ Sept8,1965
- +220. Donald C. Holst
+ CPL U.S. Army
+ Dec29,1929-Jul11,1974
- +221. SCHMITT
+ Chris W. Ester E.
+ Aug24,1902 nee Hollmann
+ Jan28,1979
+ Mar24,1908

222. Albert J. Foeste
1916-1979
223. YOUNG
Earl P. Rose M.
Feb20,1910 Feb20,1905
Oct28,1979
224. Melody G. Smith
1954-1980
225. OBERLE
Damian W. Birdie Ruth
Sept7,1895 Nov18,1896
Jan28,1981
226. Elizabeth K. Smith
nee Vogt
Sept17,1891-
227. Sylvia McKlin
228. Howard W. Parmer
1917-1982
229. Andrew A. Mead
son of Andrew Mead and Dorothy M.
(Balridge) Mead
December13,1948-October10,1972
230. HEIM
Reuben C. -
Nov23,1899 -
Jan20,1973 -
231. John H. Griffard
Nov16,1909-
232. RUPLE
John S. Zelma I.
Sept16,1906 Feb26,1916
July25,1973
233. HAUCK
Walter E. Elsie F.
Sept28,1899 Aug24,1905
- -
234. HECK
Arnia E. Goldia G.
Mar9,1917 Feb22,1922
- -
235. FIEG
Lothar Catherine
Aug22,1919 Jan9,1919
Sept15,1976
236. VAETH
Arthur J. Juanita R.
Jan12,1924 Apr8,1926
- -
237. AYERS
Orville T. "Buss" Mary Lou
May26,1912 Jan22,1910
- -
- +238. BALLINGER
+ Homer J. Frances C.
+ Sept26,1918 Sept10,1921
+ Mar13,1979 -
- +239. GRIFFARD
+ Joseph F. Erma E.
+ Nov16,1909 June18,1919
+ May7,1979
- +240. William Jokerst
+ born-Sept30,1862
+ died-Sept11,1887
- +241. Joseph Jokerst
+ born-Jan28,1821
+ died-June14,1884
- +242. VORST
+ Joseph H. Jennie R.
+ Oct9,1866 Feb2,1868
+ June14,1921 Dec10,1964
- +243. BAUMGARINER
+ Arthur J. Ida S.
+ 1896-1979 1900-1970
- +244. Charlene A. McKlin
+ Oct2,1942-Sept13,1972
- +245. Albert J. Foeste
+ WI 2 US Navy
+ World War II
+ Mar13,1916-Oct8,1979
- +246. Paul B. Bloom
+ TEC 5 U.S. Army
+ World War II
+ Aug20,1921-Oct22,1980
- +247. Damian W. Oberle
+ SGT U.S. Army
+ World War I
+ Sep7,1895-Jan28,1981
- +248. John Henry Moran
+ died-Oct5,1910
- +249. Homer J. Ballinger
+ SGT U.S. Army
+ World War II
+ Sep26,1918-Mar13,1979
- +250. Howard G. Vineyard
+ SI US Navy
+ World War II
+ Mar17,1925-Jan24,1980
- +251. James E. Martin
+ Sept28,1972-Feb28,1973
- +252. Geo. H. Byrd
+ CO A 36 Ind. Inf.
- +253. Mother
+ Mary M. Byrd
+ Oct30,1865-Jan31,1939
+

254. Henry Jokerst
born-Aug15,1854
died-Apr14,1893
255. William Fred Boatright
1896-1981
256. Michael W. Marts
1945-1981
257. SCHULZE
Arthur P. Mildred H.
nee Meyer
Mar29,1908 Junel7,1909
Sept11,1980
258. TUCKER
Virgle Grace
July22,1908 Nov16,1915
Nov25,1966
our loved ones
259. TODISMAN
James G. Margaret E.
Jan1,1866 Sept7,1868
Sept10,1944 Dec29,1945
260. Laura E. Counts
Nov4,1908-Aug9,1979
261. our darling
Virgil Ray Tucker
1943-1947
262. Virtle E. Tucker
1905-1948
He was the sunshine of our home.
263. WEILER
Edwin Oleva
Apr14,1904 Jan15,1915
May23,1957
264. HENSON
Dorothy E. Lonnie W.
Jan10,1917 Feb4,1912
July1,1958
265. Felix A. Sadler
Aug30,1899-Dec20,1959
266. Violet M. Sadler
Apr29,1919-
267. Robert Swift
Sept28,1865-Sept2,1940
268. Lucinda F. Swift
June5,1867-Apr21,1916
269. Alfred Tate
Missouri
PVT 5 Mobile Bath Unit QMC
World War I
May7,1897-March7,1953
270. Olivia E. Tate
Oct11,1910-Oct24,1978
- + 271. WOELICH
+ Jane A. Joseph W.
+ Mar27,1908 Mar23,1891
+ May11,1958 Oct24,1975
- + 272. HARRELL
+ James B. Ethel M.
+ July17,1909 Mar5,1908
+ Nov20,1962 Feb5,1973
+ The peace of God that passeth all
+ understanding
- + 273. Elmer Lee Blythe, Jr.
+ Apr21,1943-Nov29,1943
+ our darling
- + 274. Opal L. Blythe
+ Jan5,1918-Apr15,1978
- + 275. Gary Wayne Cox
+ Mar16,1943-Mar5,1951
- + 276. Walter Yates
+ 1908-1953
- + 277. Ray R. Anderson
+ Dec29,1890-Feb5,1950
- + 278. son of S.D. Campbell
+ Mar1953
- + 279. Louis W. Lunsford
+ Mar2,1915-June3,1959
- + 280. Mary Ann Boyer
+ Apr10,1880-Apr4,1959
- + 281. Proste Boyer
+ July17,1862-Apr4,1951
- + 282. Charles B. Griffard
+ Dec3,1878-June30,1959
- + 283. LeGRAND
+ A. Fred A. Pearl
+ June24,1891 June25,1906
+ Apr4,1961 July27,1966
- + 284. PAYNE
+ Thelma I. Mierlan G.
+ July12,1918 July16,1907
+ Oct18,1961
- + 285. GARRISON
+ Alvin Ralph "Dude" Rose Bernice
+ Mar12,1931 Sept10,1934
+ May3,1963
+ married-Mar27,1959
- + 286. JETT
+ Ray Zella B.
+ Sept2,1894 Feb23,1897
+ Apr6,1959 May16,1964
- + 287. PFELIFER
+ Clell R. Nellie E.
+ Jan22,1903 Nov4,1902
+ - -
+

288. Bertha Kniess
1859-1918
289. TROLLINGER
Ishmael H. Doris M.
Oct5,1926 May10,1932
Apr19,1970
290. Jerry L. Trollinger
1956-1957
291. Alfred H. Trollinger
1955-1955
292. Jesse M. Sadler
Mar25,1906-Apr22,1968
dearly beloved husband and father
293. WARREN
Roy G. Hazel M.
Apr8,1897 Oct27,1910
Apr11,1968
294. Colleen A. Fallert
Little Toni
Feb12,1959-Mar4,1959
295. Henan Gloire
1907-1968
The Lord is my refuge.
296. ACKMAN
Marie A. Wilson H.
Nov3,1927 Nov10,1912
July7,1967 Sept10,1966
297. YATES
Edward Faye
Oct3,1902 July1,1925
Apr10,1965
298. COFFELT
Velvia I. Irene T.
Dec22,1914 Jan19,1915
Oct24,1964
299. HOLDER
Claude, Sr. Lucille Claude, Jr.
Dec25,1911 Feb24,1932 Mar26,1938
Aug17,1964
300. Blanche E. Smith
June30,1892-Dec27,1963
301. EVANS
Clarence Edith
Feb14,1892 Feb26,1891
June5,1963 May24,1963
302. PAYNE
Lanny R. Bonnie B.
Oct7,1942 Feb2,1945
May31,1977
303. SHIRLEY
Lena John C.
Feb9,1906 Aug15,1892
Jan6,1971 Jan21,1978
- +304. BRUMFIELD
+ Chester A. Mabel G.
+ Nov21,1904 July28,1906
+ - -
+ Remember friends as you pass by,
+ you are now as once was I,
+ As I am now you soon will be.
+ So prepare yourself to follow me.
- +305. Zita Marie Swift
+ Jan16,1898-
- +306. Virgel Swift
+ Jan28,1898-Oct23,1961
- +307. Bertha Swift
+ Oct31,1902-Jan20,1937
- +308. BROWN
+ Leonard E. "Pete" Leatha M.
+ Feb18,1914 Mar10,1924
+ Jan30,1978
- +309. Daughter
+ Karen R. Brown
+ Oct16,1953-Sept20,1972
- +310. BOLAND
+ Gussie J. Eula M.
+ July9,1895 Feb23,1911
+ July29,1972
- +311. GIBSON
+ Noah E. Clara B.
+ May4,1914 June4,1918
+ Junell,1972
- +312. JENKINS
+ Robert Guy Eula M.
+ Jan21,1899 Feb16,1904
+ May21,1972
+ So swift the way, so short the day
+ Gone Home
- +313. Steven D. Gibson
+ born&died-Jan15,1972
- +314. STEWART
+ Richard R. Alice
+ Dec19,1883 Aug6,1891
+ July23,1974 July28,1974
- +315. JENKINS
+ Thomas Carrie
+ Apr19,1892 Feb26,1892
+ Aug6,1977 Aug23,1971
- +316. Wilson H. Ackman
+ Missouri
+ TEC 5 CO 1140 Infantry
+ World War II
+ Nov10,1912-Sept10,1966
- +317. Lilburn R. LeClere
+ Jan1,1910-
+

318.	LeCLERE		+333.	WADLOW	
	Joseph V.	Grace I.	+	Merle W.	Mary E.
	Aug16,1878	Feb11,1891	+	Aug1,1932	Oct21,1938
	Apr15,1971		+	Dec18,1975	
319.	Warren P. Seawel		+334.	KENUAM	
	Oct30,1950-Mar23,1971		+	Elmer	Rosie Lee
320.	SEAWEL		+	Feb8,1901	June22,1908
	Doyle D.	Freda V.	+	-	-
	Dec1,1921	Dec19,1923	+335.	TUCKER	
	Oct7,1975		+	Leslie R.	Sarah E.
321.	YARBROUGH		+	Jan31,1891	July9,1894
	Elbert R.	-	+	May20,1977	
	July28,1915	-	+336.	CRITES	
	Mar23,1971	-	+	Roy D.	Mary S.
	asleep in Jesus		+	Oct23,1924	Aug25,1929
322.	Luther W. Baw		+	Mar25,1977	
	Dec7,1884-Sept22,1970		+337.	Warren Paul Seawel	
323.	Clarence Evans		+	Missouri	
	Missouri		+	CPL HHB 77 ARTY 101 ABN DIV	
	Wagoner 10 Fld Arty Brig		+	Vietnam BSM-Arcom-PH	
	World War I		+	Oct30,1950-Mar23,1971	
	Feb14,1892-June5,1963		+338.	GRASS-BOYER	
324.	WEHMEYER		+	Irene M.	Norene E.
	Edward L.	Clara Belle	+	July11,1900	May1,1923
	Aug16,1920	June12,1921	+	-	-
	Sept12,1970		+339.	Doyle D. Seawel	
325.	John G. Shirley		+	PFC U.S. Army	
	PVT U.S. Army		+	World War II	
	World War I		+	Dec1,1921-Oct7,1975	
	Aug15,1892-Jan21,1978		+340.	George W. Yates	
326.	Darrin Ham		+	Feb22,1935-Mar5,1975	
	1977-1977		+341.	Felix G. Boyer	
327.	John W. Kirk		+	Nov10,1911-July11,1974	
	Jan2,1880-Apr28,1975		+342.	SKAGGS	
328.	Mabel V. Kirk		+	Loyd E. Virginia Faye Winifred M	
	Nov11,1875-Sept12,1916		+	June25,1915 Nov12,1956 July2,1922	
329.	FITZKAM		+	June16,1974	
	Oliver J.	Katherine N.	+343.	BRAKE	
	Nov22,1912	July31,1922	+	Charles A.	Tempey L.
	-	-	+	Dec12,1903	Mar11,1905
	-	-	+	June16,1977	
330.	Gussie J. Boland		+344.	Edward L. Wehmeyer	
	Missouri		+	Missouri	
	SGT U.S. Army		+	CPL 749 Base Unit AAF	
	World War I		+	World War II	
	July9,1895-July29,1972		+	Aug16,1920-Sept12,1970	
331.	ARNOLD		+345.	FINLEY	
	James F.	Louie F.	+	Mary Ann Roy E.	-
	Jan20,1900	July8,1902	+	May4,1951 Apr21,1925	-
	Apr16,1977		+	Oct12,1965 Dec5,1972	-
332.	McCLANAHAN		+		
	Robert W.	Mary E.	+		
	May23,1893	Apr19,1889	+		
		Sept7,1976	+		

346. BRAKE
 Silas W. (Bill) Nancy A.
 Aug27,1935 Nov25,1935
 Nov8,1972
347. BRAKE
 Harold G. Dorothy B.
 Sept24,1937 Aug2,1944
 Nov8,1972
348. LORANCE
 Delmas D. Betty L.
 Oct1,1927 May27,1940
 Nov8,1972
349. Roy J. Brown
 1900-1982
350. Merle Walter Wadlow
 PFC U.S. Army
 Korea
 1932-1975
351. Fred Kaylor
 Mar24,1902-Sept12,1980
 The Lord is my refuge.
352. Duke Kaylor
 Mar1,1957-July24,1980
 The Lord is my refuge.
353. Samuel E. McCullar
 1951-1980
354. JENKINS
 Father Mother
 Arnel L. "Tim" Enid M. "Net"
 Oct17,1913 June24,1922
 - -
355. BOLAND
 Randolph Lee Zella Ann
 July24,1907 Aug4,1909
 Junel9,1980
356. Leslie R. Tucker
 PVT U.S. Army
 World War I
 Jan31,1891-May20,1977
357. Roy D. Crites
 U.S. Navy
 World War II
 Oct23,1924-Mar25,1977
358. FARRIS
 Lewis J. Frances Leoma
 Nov12,1913 May10,1906
 Nov3,1979
359. Ida Bell Needham
 1915-1979
360. George W. Yates
 SGT U.S. Army
 Feb22,1935-May5,1975
- + 361. George H. Davis
 + Mar13,1905-May29,1979
- + 362. BROWN
 + Herbert J. Bessie M.
 + Sept27,1898 July5,1899
 + Apr13,1979
- + 363. Alvin L. Jokerst
 + SN US Navy
 + Korea
 + Aug8,1927-Feb15,1979
- + 364. Ucal G. Vineyard
 + Missouri
 + TEC 5 U.S. Army
 + World War II
 + Feb15,1909-June14,1973
- + 365. Janis E. Meyer
 + 1942-1978
- + 366. Roy E. Finley
 + Missouri
 + S1 U.S. Navy
 + World War II
 + April21,1925-Dec5,1972
- + 367. Donna Marie Boyer Basler
 + our beloved wife & mother
 + 1956-1977
- + 368. Alvin W. Sadler
 + PHM 3 US Navy
 + World War II
 + Sep3,1926-Oct19,1977
- + 369. E. McCulla
 + 1925-1977
- + 370. Delmas D. Lorange
 + Missouri
 + PFC U.S. Army
 + Korea
 + Oct1,1929-Nov8,1972
- + 371. SCHAAF
 + Herman Lelia F.
 + Feb22,1895 Jan23,1901
 + May26,1977 June28,1978
- + 372. Herman Schaaf, Sr.
 + PVT U.S. Army
 + World War I
 + Feb2,1895-May26,1977
- + 373. Hiram Berry
 + Co. C 21st MO INF
- + 374. CHS. JOKERST
 + born-Nov4,1848
 + died-June11,1882
- + 375. Charles Beauvais
 + died-Jan7,1882
 + aged-42yrs., 9ms., 5d's
 +

14 15	16 17 18 19 20	21 22 23 24	25 26 27 28	29 30 31 32
38	40	41 42 43	44 45 46	47 48 49 50 51 52
56	57 58 59 60 61 62 63	64 65 66	67 68 69	70 71
97 98	99 A0 A1 A2 A3	A4 A5 A6 A7	A8 A9 B0 B1 B2 B3 B4 B5 B6	
D4 D5 D6	D7 D8 D9	E0 E1 E2 E3 E4 E5 E6 E7	E8	
H0	H1 H2	H3 H4	H5 H6 H7 H8	H9 I0 I1
K7 K8	K9	L0 L1 L2 L3 L4	L5 L6	L7 L8 L9
N4	N5 N6 N7 N8 N9		O0 O1	
	O9 P0	P1 P2 P3 P4	O2 O3 O4	

Road

Q5

R4 R5 R6 R7	R8 R9 S0 S1 S2 S3 S4	S5 S6 S7
T6 T7 T8 T9	U0 U1 U2 U3 U4	
V6 V7 V8 V9 W0	W1 W2 W3 W4 W5	
X6 X7 X8 X9 Y0 Y1 Y2	Y3 Y4 Y5 Y6 Y7 Y8	
Z7 Z8 Z9 a0 a1 a2 a3 a4 a5 a6	a7 a8 a9	b1 b2

b3

b4 b5

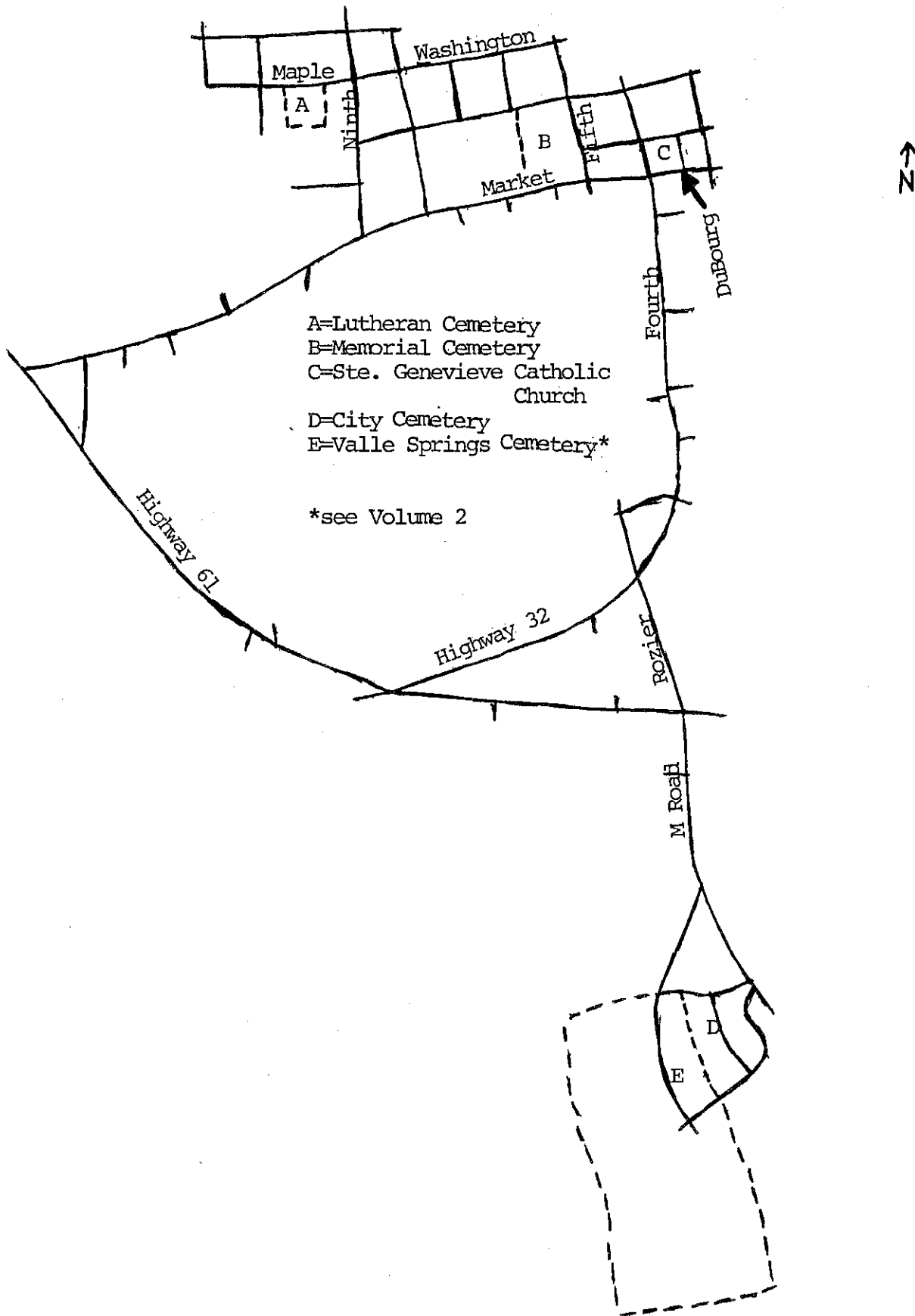

1. Luther Arle
 infant son of Mr. & Mrs. Earl Whaley
 Died-Nov5,1913
 Aged-1 Month
2. Branden Adhilt
 son of P.H. & L.E. Schroeder
 born-Jan30,1905
 died-Aug8,1905
 Budded on earth to bloom in heaven.
3. BAUMGARTNER
 John Marie Eva
 born-Mar25,1827 born-Dec25,1836
 died-Dec15,1905 died-July5,1910
 aged-78yrs. 8m. 20d. aged-73yrs. 6m. 10d.
4. August Baumgartner
 born-Mar9,1856
 died-May22,1904
 aged-43yrs, 2m, 13d
5. Baby Girl Kontz
 1930-1930
6. Robert L. Kontz
 born-Sept10,1925
 died-Sept11,1925
7. Fredricke Schaefer
 born-Oct22,1843
 died-May29,1904
8. Frederic G. Petrequin
 né le 13Fevrier1828
 décédé le 8Octobrel899
 Catherine Petrequin
 née Guilloz
 décédée le 10Sept1906
 agée-75a, 5m, 14j
9. Charles H. Biel
 born-Nov17,1838
 died-May19,1910
 Sophie Biel
 born-Feb5,1852
 died-Jan2,1922
10. Our Darling
 Glennon D. H-E--LING
 born-Dec6,1927
 died-Oct-,1929
 Baby
11. Henry Schaefer
 born-Aug17,1849
 died-Sept2,1894
12. WUNDERLICH
 Elisa A. William E.
 Feb18,1914 Feb4,1906
 Feb19,1978 Nov27,1968
- +13. KRIEGER
 + Clarence W. Eula M.
 + Aug16,1909 Aug14,1911
 + Sept27,1967 Nov2,1965
- +14. SEXAUER
 + Hier Ruhet In Gott
 + Georg Francesca
 + Geboren Nee Perret
 + zu Mundingen Born-La Chaux de
 + in Baden Fonds, Neufchatel
 + Nov24,1814 June22,1823
 + Gestorben... Died-Ste. Genevieve
 + Ste. Genevieve Co., MO
 + Co., MO July10,1906
 + Apr14,1892
- +15. Henry Sexauer
 + born-Feb10,1852
 + died-Mar11,1923
- +16. George W. son of H.&L. Bauer
 + born-Jan17,1891
 + died-Jan14,1908
 + The rose may fade; the lily die;
 + But flowers immortal bloom on high.
 + Thomas son of H.&L. Bauer
 + born-Nov23,1892
 + died-July23,1909
- +17. ----- Sexauer
 + born-Feb22,1888
 + died-Sept18,1888
 + aged-6mon, 22ds
- +18. Tillie J. Schirmer
 + March30,1908-June25,1981
- +19. Michael E. Whiteside
 + Sept17,1952-Apr28,1970
- +20. KUEKER
 + Louis Christina
 + Feb20,1882 Feb7,1888
 + Sept25,1970 Mar9,1965
- +21. SEXAUER
 + Louise Joseph
 + 1868-1946 1858-1940
- +22. Katie wife of Joseph Sexauer
 + born-April19,1863
 + died-April16,1892
 + Gone but not forgotten
- +23. Henry Herter
 + born-Mar14,1814
 + died-Feb5,1890
- +24. VALLE
 + John H. Thersa
 + Feb2,1878 Sept20,1876
 + Apr9,1961 Mar14,1959
 +

25. LUEKER
Karl F. Alma A.
Aug23,1907asleep Feb28,1913
- in Jesus -
26. Dorothy Schaefer Haertling
Sept22,1900-Apr18,1981
Dear Jesus I love you.
27. GROBE
Welton G. Virginia E.
Mar24,1910 Jan20,1919
- -
The Lord is My Shepherd.
28. GROBE
Annie C. Emile L.
Aug16,1884 Mar3,1877
Feb8,1977 June22,1946
29. Anna Schuler
born-Feb14,1859
died-Feb21,1908
Charles Schuler
born-Jan26,1842
died-July13,1932
30. LUX
FATHER MOTHER
Louis Mary
Nov27,1841 Sept12,1841
Aug30,1928 June14,1905
31. KUEKER
Brother Sister
Herman F. Esther F.
Nov13,1909 Mar9,1927
Dec3,1980
32. Rosa dau of Joseph&Katie Sexauer
died-July2,1887
aged-4mon,18days
33. Hilda C.W. dau of Joseph&Katie
Sexauer

34. Joseph G. son of Joseph&Katie
Sexauer
died-June12,1890
aged-4mon,26days
35. John Denler
born-Mar22,1852
died-Oct20,1911
36. MOTHER
Magdalena Denler
1852-1933
37. Mother
Margaret Roussin
1914-1965
- +38. Geraldine Allen
+ June26,1932-Aug15,1951
- +39. GROBE
+ Henry J. Anna F.H.
+ Jan14,1831 Nov28,1838
+ April19,1892 Mar7,1912
- +40. Irene D. Fisher
+ Feb23,1912-June23,1961
- +41. Louise Marie DaVitz
+ Aug13,1863-July6,1943
- +42. George A.B. husband of Barbara A.
+ Bauer
+ born-Feb2,1834
+ died-April12,1898
+ Barbara A. wife of George Bauer
+ born-March17,1834
+ died-Sept11,1898
- +43. Luther Bradford
+ son of Henry Bauer & wife
+ born-May31,1898
+ died-Jan29,1901
- +44. BAUER
+ Henry Lily B.
+ Apr18,1859 Aug5,1866
+ Oct27,1928 Sept9,1907
- +45. ROTH
+ Charles A. Lena S.
+ Feb21,1888 Feb18,1890
+ Oct29,1966 Mar12,1962
- +46. PARKER
+ Chalmer Sylvia A.
+ Oct30,1913 Dec22,1916
+ Dec16,1968
- +47. Wilhelmine Valle nee Luecke
+ Mar15,1835-Dec13,1889
+ born in Hanover, GERMANY
- +48. KRUSE
+ Arthur W. Lucy E.
+ May8,1915 Jan7,1913
+ Mar15,1972
- +49. DIETZFELBINGER
+ John B. Isabelle A.
+ July16,1898 Dec12,1909
+ Sept3,1974
- +50. Edward Seyssler
+ Born in Baden in Germany
+ Feb28,1840
+ Died-at Ste. Genevieve, MO
+ June30,1884
+ Aged-43yrs,11mon,2d
+
+
+

51. Hier Ruhet in Frieden
Wilhelmine Kruse
Geboren-Nov1,1820
Gestoroben-Dec10,1883
Erected buy her son's J.&F. Kruse
52. Marian F. nee Seysler Clark
Sept2,1865-Dec28,1957
53. Ashley H. Clark
1859-1922
54. Leola I. née Clark VanGundy
Nov18,1890-May13,1928
55. MUELLER
Caroline A. Chauncey L.
nee Valle
5-9-1869 7-26-1869
12-28-1924 6-10-1952
56. Ida Meckfessel nee Mueller
1907-1964
57. Georg H. son of George&Barbara Bauer
Geboren-Feb9,1870
Gestoroben-Aprill13,1884
58. our father&mother
natives of Hanover, Germany
Augusta Louisa wife of C.H. Meyers
born-Dec19,1821
died-Aug28,1896
Christian H. Meyers
born-Apr12,1812
died-July19,1871
59. Mary Augusta
daughter of Chas.&Amanda Meyers
born-Sept5,1886
died-Jan25,1894
60. our grandfather&mother
natives of Hanover, Germany
Geo. F.L. Hartmann
born-Jan29,1798
died-Sep13,1868
Johanna G. wife of G.F.L. Hartmann
born-Aug7,1799
died-May9,1892
61. H.C. Meder
born-Dec21,1870
died-Aug1,1888
62. CLARK
Robert M. Irma M.
May2,1908 Feb24,1909
Nov14,1978
63. August F. Wittemeyer
native of Prussia
born-Oct1,1841
died-Aug16,1867
- +64. Erestina Schoenfeld
+ wife of Christoph Peterson
+ born-Dec21,1822
+ died-Feb24,1883
- +65. Christoph Peterson
+ died-July20,1885
+ aged-62 years
- +66. Genevieve Roth
+ born-Jan2,1814
+ died-Nov20,1888
- +67. Hier ruhet in Gott
+ Virginia Roth
+ Geborne Suel
+ Geb.-15Oct1815
+ Gest.-21Mar1895
- +68. Maria A. Hehr nee Yenny
+ born-Feb9,1850
+ died-Apr27,1923
- +69. Henry D. Schremp
+ born-Nov3,1879
+ died-Feb2,1923
- +70. Hier Ruht in Gott
+ Du- Suille von
+ Catherine Schuler
+ Geborn-----
+ Gestorben-----
- +71. William P. Konemenn
+ July25,1845-July16,1880
- +72. Pierre Pinchot
+ died-Jun11,1881
+ age-68 years
- +73. August Lutze
+ born-1835
+ died-Jan6,1885
- +74. P.U. Jaccard
+ 1833-1885
- +75. Jacob J. Schuler
+ born-Dec20,1806
+ died-Aug3,1887
- +76. Albertina Schoenfeld
+ wife of Jos. Grein
+ born-Feb24,1821
+ died-Jan24,1889
- +77. Amelia Sophia nee Schoenfeld
+ wife of C.H. Biel
+ died-Oct16,1888
+ aged-61yrs,3m,7d
- +78. Elisabeth
+ Todder ean Georg&Barbara Bauer
+ Geb.-27Mar1857
+ Gest.-7Jul1877
+

- 79. Anna J. Keller +
- Geb. 11 Feb 1875 +
- Gest. 16 Jul 1878 +
- 80. Katharina +
- tadder ean Georg & Barbara Bauer +
- Geb. -22 Nov 1873 +
- Gest. -11 Sept 1876 +

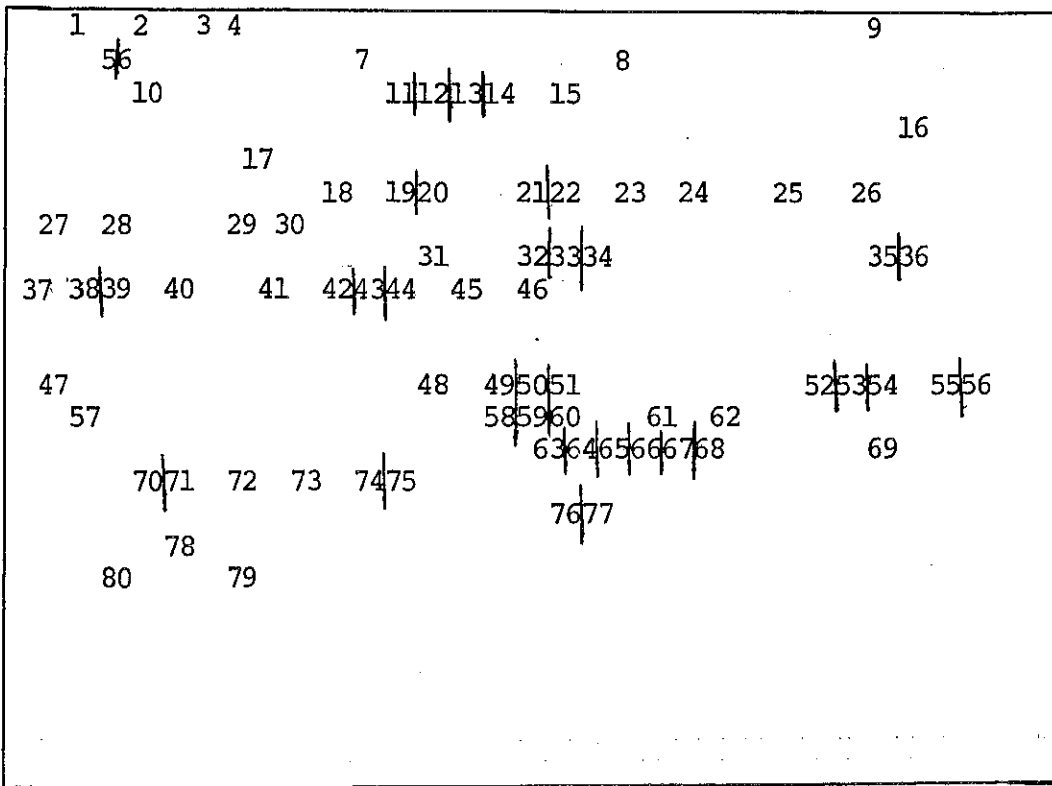

Maple

1. Mary Moreau
consort of Peter Moreau
Born the 25th of December, 18-0
Died the 8th September, 1830
2. Ci Git
Basil Simonot
Née le 4 Juillet 1795
Mort le 5 Août 1845
3. Sacred to the memory of
---t---ah---
4. Ici Git
Pelagie Adelaide
de Barthelew Ste. Gemme
Née 7 Mars 1814
Le 29.8 Bie
5. ici git
Felix Thomure
né le 16 Decembre 1825
mort le 22 Juin 1847
age de 21 ans, 6 mois, 6 jours
6. Sacred to the memory of
Dennis McGill
(a native of Killybegs, Ireland)
died-June 22nd, 1844
aged-33 years
This monument was erected by the
shipmates of the deceased.
A LaGrave & Co. contributors
Edward Anderson/John B. Fisher/Elie G.
Boyer/James Goar/Joseph Cox/Hugh
Pritter/James Murray/William Dukes/
James P. Childs/John Jeffries/John
Gold/John M. Smith/Christopher O.
Madwell/Francois L. Guye/Michael
Maguyre/Jeremiah Hogan/Sam Head/
William Cudmore
7. Leon Maurice
Mort le 24 Octobre 1844
age de 3 ans
8. Pierre Maurice
Mort le 28 Août 1845
age de 19 ans
9. Ici Git
Marie Louise épouse d'Antoine Winston
née le 13 Juillet 1815
morte le -----1865
10. In memory of
Cornelia Winston consort of Ely Boyer
born-June 18, 1837
died-May 24, 1855
Ely her child
died-May 31, 1855
aged-9 days
- +11. Famille LaGrave
- +12. In memory of Andrew Anderson
+ born-March 14, 1821
+ at Flenzburg, Schleswig-Holstein
+ died-May 12, 1871
- +13. hier ruhet
+ Gottlob Bebion
+ geb. in Fellbach Kön. Württ,
+ Deutchla., 14 Febr. 1843
+ gestorben-27 Juni 1873
+ Ruhe seiner Wlche
- +14. hier ruht
+ Geliebte Mütter
+ Anna Bebion
+ Geboren der 15-----1797-Württemberg
+ Gestorben der 11 Januar 18-5 in
+ Ste. Genevieve
+ Fried- ----- --che
- +15. In memory of our mother
+ Mary A. Guilloz
- +16. Philomena
+ wife of Edmond Price
+ born the 9th Oct, 1838
+ died-April 18th, 1862
+ aged-23 yrs, 6 mos.
- +17. Henry August Aubuchon
+ ne à Ste. Genevieve le 9 Fevrier
+ L'anne 1818
+ desede le 13 Decembre L'anne 1845
+ -----27 ans, 10----
- +18. -----
+ Erogenia
+ -----
+ -----
+ Laurence Sucher
+ Geb. 1822
+ Gest. d. 3 Mar 1850
+ Alter 18 Jahren
- +19. Erste Gattin Von
+ Laurence Sucher
+ Geb-Sept 1822
+ Gest-d. 6 Mar 1843
+ Alter 21 Jahren
- +20. Ci Git
+ Joseph Carron
+ ne le 25 May 1787
+ decede le 12 Avril 1845
- +21. Octave Thomure
+ née le 8 Octobre 1854
+ décédé le 18 Avril 1857
+
+
+

22. Antoine Thomure
né le 23Avrill1787
décédé le 26Septembre1844
agé de 57 ans
23. Pierre E. de Vallé
est mort le 20Avrill1845
age-56 ans
24. Charles E. Nauman Anna M. Nauman
died-Mar9,1875 died-Nov27,1867
aged-1mo,9d's aged-2 days
Catharine E. Nauman
died-Apr14,1867
10 mon's
Sweet little buds for earth too fair
Have come to Heaven to blossom there.
25. John B. Vallé
May3,1827-Aug22,1869
26. In memory of Mary M. St. Gemme
consort of John B. Valle
born-Feb29,1832
died-Mar6,1853
aged-21yrs,6dys
27. A la memoire de Joseph Potier
mort à Ste. Genevieve Julet18,1868
agé de 71 ans
N'ayant pas des parant ici je
solicite les prieres de passants.
R.I.P.
28. Saveur Detchemendy
born-Mar17,1809
died-Sep29,1869
L--- E.P.
dau of S.&R. Detchemendy
born-Jan13,1850
died-Aug5,1869
29. Augustin Schweiss
born-Aug28,1829
died-13Jan1880
30. John Moro
born-1840
died-April 15, A.D. 1861
aged-21yrs
Mary Moro
born-1844
died-April 14, A.D. 1861
aged-17yrs
R.I.P.
31. To the memory of Wm. Skewes
born in Cornwall, Eng. Jan19,1806
died in Ste. Genevieve, MO Feb6,1868
Requiescat in Pace
- +32. To the memory of Steven Augustus
+ only son of Gustavus & Lizzie St. Gem.
+ died-Dec6,1862
+ Aged-6yrs,9ms,9ds
- +33. Sacred to the memory of Louisa
+ beloved daughter of
+ William & Eliza Skewes
+ died-Nov20,1862
+ aged-23yrs,2ms
- +34. In memory of Clara Emely Calliott
+ born-March the 20th, 1878
+ died-January the 26th, 1880
- +35. In memory of
+ Odile Josephine Calliott
+ born-Aprill8,1863
+ died-Febr'y14,1864
- +36. Francis M. Simonot
+ born-July24,1850
+ died-Augst30,1850
- +37. Marie Josephine Marchal
+ nee en France
+ morte le 4Sept1851
+ agée ----- ans
- +38. In memory
+ Cath-----yer Joseph Hettig
+ ----- born-Jan26,1856
+ Fid----- died-Feb11,1856
+ born----- Fidel A. Hettig
+ died----- born-Auy27,1858
+ Charles ----- died-Sept13,1858
+ born-Oct-----
+ died-Aug-----
+ August -----
+ born-Mar17-----
+ died-Mar30-----
- +39. Katharina Nager
+ consort of Felix Hettig
+ born-Aug28,1834
+ died-Sept5,1860
+ aged-26y
- +40. Antoine Lalumendiere
+ né le 10Sept1800
+ décédé le 20Dec1852
+ agé de 52 ans
- +41. -----
+ mort le 10----1859
+ age de 72
+ -----
+ July21,1884
+ R.I.P.
- +42. Mary-----
+ ----- of J.J. & Emil-- Wilson
+ born-Oct12-----

43. James Ferd.
son of James & Emily Wilson
died-July 21, 1871
aged-----7mo, 12d
44. Lizy Jane
dau of James & Emily Wilson
died-Oct 7, 1863
aged-7yr, 9mo, 16d
45. In memory of Thomas J. Brady
born-Oct 4, 1821
died-Sept 6, 1860
aged-38yr, 11mon, 2d
46. Hier ruhet in Gott
Dorothea Schramm
Geboren der 23Mar1804
Gestorben der 4Decl873
Jesus spricht Ich bindie Auferstehung
und das Leben. Wer an mich christ
der wird leber -----g-----ht
47. Children of CER. & W. LUICKE
48. Frederich Henry
born-Sept 15, 1872 born-Nov 21, 1871
died-Nov 3, 1874 died-Jan 13, 1880
children of Frederick & Marguereth
Raabe
49. W.C. Emil.
son of C. & W. Luicke
born-Nov 28, 1871
died-Aug 14, 1872
50. Amos
son of A. & A.A. Culver
died-Nov 4, 1866
aged-20yrs, 5ms, 28ds
51. ici repose
Noe Thomure
né le 25Décembre 1852
décédé le 17Décembre 1860
52. Here rests the body of
Francois Duran
born-Feb 17, 1792
died-Sep 30, 1864
53. Rosati LaSource
né Fév 15, 1828
mor le 18Decl858
54. In memory of ----- Brugere
born-Sept 3, 1834
died-----, 1877
55. In memory of ----- Brugere
consort of ----- Vilars
born-----1815
died-----1856
- +56. To the memory of
+ Adelaide Brugere
+ consort of Anthony Brugere
+ born-Sept--, 1794
+ died-----3, 1876
- +57. In memory of Mary Anna Rottler
+ born-April the 13th, 1871
+ died-March the 16th, 1879
- +58. Marie L. Bonnoau
+ Mée Placete
+ Morte le 7Sep1863
+ aée de 69 ans
- +59. ----- memory Elizabeth Hanlan
+ dec^d Mar 21st, A.D. 1849
+ aged-25 years
- +60. Ba----- Lalumondiere
ne le -----
+ -----ans
+ -----mois
- +61. Here rest in peace Henry Manly
+ aged-53 years
+ 1862
- +62. In memory of H.W. Luecke
+ son of Chr. & Anna Luecke
+ born-Oct 10th, 1873
+ died-July 1st, 1874
- +63. Augustus W.
+ died-Dec 13, 1860
+ aged-3yr, 5m, 15ds
+ -----
+ died-Oct 1860
+ aged-----
- +64. Here rests the bodies of
+ Elvena LaRose
+ born-Dec 31, 1833
+ died-Oct 20, 1859
+ -----eaise LaRose
+ born-Aug 11, 1858
+ died-June 27, 1860
- +65. Sacred to the memory of
+ John Montgomery
+ born-25-----1789
+ who departed this life the 23th of
+ October A.D. 1856
+ aged 67 years
+ R.I.P.
- +66. John Ribeault
+ died-April, 1849
- +67. Antoine Beltrami
+ décédé 28Fevl866
+ a l'age de 55a, 5m, 20j
+ ----- le mort qui se sont -----.
+ R.I.P.

68. Felicite B.
 wife of C.E. Moss
 born-March6,1851
 died-March12,1872
 aged-2lyrs & 6ds
 R.I.P.
 Charles F.
 son of C.E. & Felicite B. Moss
 died-Jan30,1872
69. Jean Baptiste Moreau
 ne le 9Janvier,1781
 mort le 25Avril,1849
70. In memory of
 Gertrud Saelinger Hauser
 born-March10,1783
 died-Oct26,1872
 erected by her mourning daughter
 Mary A. Ringwald
71. Josephine R.
 dau of F. & T. Jokerst
 born-Nov29th,1879
 died-Feb18th,1880
72. In memory of
 Michael Klein
 died-1864
 aged-64years & 11 months
 R.I.P.
 In memory of Caroline Baum
 born-January27th,1838
 died-Mar23,1877
 aged-39years, 1mon, 24days
 R.I.P.
73. Mary Felicity B.
 who died March26,1851
 aged-4years
 In memory of Emily
 consort of A. Beltrami
 who died April 15,1855
 aged-33years
 and of their children yiz.
 Joseph B.
 who died June18,1855
 aged-2mos,15days
 Mary Agnes B.
 who died June29,1851
 aged-8mos.
74. Ci Git
 Ernestine Pernot
 décédé le 8July1832
 âgée de 22 mois
- +75. Neree Auguste
 + son of Neree Valle and Aglaee
 + Chouteau
 + born-7thJan'y,1851
 + died-Sept,1851
- +76. Neree
 + son of Neree Valle & Aglaee Chouteau
 + born-21February1849
 + died-18thMar1849
- +77. Henry Theobald Seebach
 + born-March25,1865
 + died-July22,1866
- +78. Mary B.
 + wife of Ralph Leavenworth
 + born-Sep17,1800
 + died-May14,1868
 + aged-68ys, 7m, 3d
 + Blessed are the pure in heart for
 + they shall see.
- +79. Memory of Marie Schilli
 + born-August23,1823
 + died-January18,1858
- +80. Sacred to the memory of
 + Mary Chrisuell
 + who died on the 17 day of
 + September,1854
 + aged-33years
- +81. Baptiste Thomure
 + né le 18Fevrier1835
 + mort le 8Janvier1858
 + Adele L. Thomure
 + née le 25Octobre1849
 + mort le 3Septembre1858
- +82. Ci git
 + Gabriel Thomur
 + mort le 17Juin1858
 + agé de 66 ans
- +83. Sacred to the memory of
 + Charles Jokerst
 + born in Baden, Germany
 + May 6th A.D. 1821
 + died-July 16th A.D. 1854
- +84. Lucy Ann Moro
 + consort of Peter Moro
 + born-Nov12th,1830
 + died-March11th,1854
- +85. DeLaFONT
 + Jean Baptiste Charlotte LaCourse
 + 1739-1790 1740-1788
 +
 +
 +

86. Ci git
 B.S.----- Ma----- Prat
 né ----Avril, -- le 31-----vier,
 1822 1821
 décédé le 23 décédé le 17Octobre,
 -----bre,1823 1823
- 87.Memory of
 John A. Guignon
 born-Dec--183-
 died-Sept23,1869
 Pray for him & may he Rest in Peace.
- 88.In memoriam Eliza M.
 daughter of Simon A. & Carmelite
 Guignon
 died-20Sep1863
 aged-20years
 Idolized daughter, beloved sister,
 sweet friend rest in peace.
- 89.ici repose
 Emelie Bequette
 femme de Gabriel Thomur
 née le 4September1792
 morte le 13Aout1856
 agée de 63 ans, 9 jours
- 90.Here rest in peace
 J.A. Ziegler
 aged-67yrs.
 1862
- 91.Francis B.Schmitt M.Eleanora Schmitt
 born-Dec21,1855 born-Nov1,1857
 died-July22,1861 died-Aug17,1861
- 92.Memory of Mary Peish
 consort of George Peish
 born-Sep14,1822
 died in St.Louis Oct18,1855
 aged-33years
 Louisa Peish
 daughter of George & Mary Peish
 died-July12,1854
 aged-4month
 George
 son of George & Mary Peish
 died on the 23 of October, 1855
- 93.I hope and I repose in the shade of
 the Cross.
 John B. Drury
 died-December4th,1849
 aged-55yrs.
- 94.ici gite
 Jean Noel Caillot
 ne le 15Avrill1808
 mort le 14Septembrel845
- +95.Ici repose
 + Marie Rosalie Caillot
 + née le 28May1815
 + décédée le 8Novembrel843
- +96.Teresa Burgert Rosean Burgert
 + born-Sept--1854 born-Sept--1858
 + died-Dece--1861 died-Octo--1860
 + Little ----- to me for
 + -- of ---- the Kingdom of Heaven.
- +97.In memory of Hedwig Baum
 + born-February--1879
 + died-February--1880
- +98.Pierre Dorlac
 + né le 6 de Juillet1794
 + décédé le 7 de Mail854
- +99.Ici repose
 + -----
 + ne Octobrel799
 + mort 12Decembrel835
 + Ici repose
 + Marie Louise Ortense Dorlac
 + née Robert le 3Janvier1802
 + morte le 6Novembrel844
- +100.Erected in the memory of
 + Marie Bogy né Beauvais
 + widow of Joseph Bogy dec'd
 + born at Kaskaskia, Illinois
 + February26,1786
 + died at St.Louis, Missouri
 + February8,1876
 + Aged ninety years less eighteen
 + days.
 + May she rest in peace.
- +101.Ci Git Joseph Bogy
 + né au Kaskaskia le 24Avrill1782
 + mort à Ste.Genevieve le 24Fevrier
 + 1842
 + age de 59 ans & 10 mois
 + Jamais mari et pere fut plus
 + regretté. Par sa femme et ses
 + enfants. L'une et l'autre conser-
 + rent pour toujours sa mémoire.
- +102.Hilaire LeCompte
 + né a Ste. Genevieve le 26Décembre
 + 1840
 + décédé le 5Juin1842
 + agé de 17mois,10jours
 + Laissez venir à moi les empêchez
 + point semblables que le appartient

103. Joseph Hilaire LeCompte
né à Ste. Genevieve le 24 Janvier 1842+
décédé le 3 Mars 1845
agé de 2 ans, 1 mois, 7 jours
les petits enfans et ne car c'est a
leurs Royaume de Dieu
Luc chap. XVIII v. XVI
104. Theresia Geiler
died-1863 AP 27
aged-6 months
105. In memory of
Mary Frazier
died-Decl 2th in the 75th year of her
life
106. Clotide Mourice
décédée le 13 Del 1856
agée de 24 ans
107. George Doll
died-20-----1878
aged-17yrs, 9mo, 2 -----
108. Theophile Dufour
né le 5 Oct 1805
mort le 28 Oct-----
109. Elizabeth wife of John Brooks
born-Jan 12, 1849
died-Jan 12, 1874
110. Ci Git Caroline Badeau
nee Cavalier le 11 January 1800
décédé le 1-----1860
111. Marguerite
wife of Lewis Skewes
died-Feb 13th, 1861
aged-22yrs.
Also her 2 children
112. ----- Lalumendiere
born-1829
died-----
113. Odile LaRose
died-Jan--, 1873
aged-----
114. Felix LaRose
born-Feb 28, 18--
died-Decl 7, 1867
Blessed are the ----- for they
shall -----.
115. Amable Amoureux
born-September 11th, 1857
died-April, 1861
aged-3years & 6months
116. Samhsion Hurtzell
died-June 1st, 1851
- +117. In memory of
Catharine Adams
+ who was born AD 1792
+ and died Oct the 26th, 1834
+ aged-42 years
- +118. In memory of Anna Meyer
+ born-1805
+ died-Feb 22, 1875
+ R.I.P.
- +119. In memory of John Huck
+ born-August 4th, 1870
+ died-August 30, 1876
+ R.I.P.
- +120. Sacred to the memory of
+ William Adams
+ who was born April the 1st, 1791
+ and departed this life
+ July the 23rd, 1846
- +121. M. Constance
+ born-28 Mar 1858
+ died-Mar 18, 1862
- +122. J.B. D-----ide Bequette
+ mort le --Sept-----
+ age de 28 ---
- +123. ici repose
+ Polline Dufour
+ née André le 27 Decembre 1819
+ morte le 3 Juillet 1854
- +124. In memory of
+ George Levié Boyer
+ born-January 20, 1858
+ died-August 25, 1859
- +125. Mary Louise C. Contancin
+ died-July 18, 1859
+ aged-23yrs, 1mon, 2dys
- +126. ici repose
+ Marie L.C. Contancin
+ décédée le 18 Juillet 1859
+ agée 23 ans
- +127. John G. Contancin
+ died-June 30, 1864
+ aged-64years
- +128. M. Ema Kempf
+ died-April 18, 1854
+ aged-13month
+ Emelie Kempf
+ born-March 31, 1855
+ died-September 23, 1856
- +129. ici repose Marie Thérèse Guibourd
+ née St. Gemme
+ née le 12 Janvier 1807
+ décédée le 26 Novembre 1859
+

130. John L.
 son of John L. & ----- Bogy
 born-Feb1-,1861
 died-----
 aged-5y,6m,15d
131. Edwin J. Valle
 son of F.L. & M.L. Valle
 born-Sep13,1864
 died-Oct26,1864
 aged-1mo. & 13d's
132. Louis Joseph Valle
 born-June24,1859
 died-Dec6,1861
 son of Frs. L. and Mary Valle
133. In memory of
 Eliza Ste. Gemme Valle
 ----- C.C. Valle
 born-----
 died-June-----
134. In memory of Francis Anthony Kempf
 born-Et----- Elsave
 Jan--,1827
 died-J-----1870
135. In memory of Louise Thomure
 born-Oct28,1850
 died-Dec4,1855
 Josephine Thomure
 born-May2-,18--
 died-Jan1-,18--
 ----- Thomure
 born-----20,185-
 died-----16,185-
136. In memory of Henry Seckinger
 born-October 2th,1851
 died-July 8th,1854
 aged-2years, 9month
137. Marie B. St. Gemme
 née LaSource l'an 1777
 décédée le 3Novembre1824
138. Melanie infant daughter
 of I.S. and Mary LeClere
 Novem the 16,1846
139. ici repose
 Charles C. Valle
 né le 5Mars1799
 décédé le 7Dec1838
140. Clara B.
 dau of L.B. & Philo E. Valle
 died-Dec7,1866
 aged-1yr,5m,25d
- +141. Antoinette Boverie
 + morte le 29Decembre1844
 + agée de 24 ans
 + ----- Boverie
 + mort le --Juillet18--
 + age de -- ans
- +142. Joseph Chable Boverie
 + mort le 19Juillet1852
 + age de 10 ans
- +143. Camille
 + son of Jules F. & Mary A. Janis
 + died-Sep26,1864
 + aged-1y,3m,21d
- +144. A.M. Boverie
 + Nov19,1851-Feb16,1875
- +145. our Father and Mother
 + Peter Moser Louise
 + born wife of Peter Moser
 + July12,1785 born-June13,1800
 + died died-Oct1,1878
 + July31,1860
 + Gone but not forgotten
- +146. ici repose
 + J.B.S. Pratte
 + mort le 25Septembre1826
 + age de 88 ans
 + cette pierre humble tribut de
 + respect et de veneration pour sa
 + memoire lui est consacrée par ses
 + petits fils
 + Evariste F. Pratte
 + Bernard Pratte
- +147. Ci Git Vital St.Gemme
 + mort le 15Janvier1824
 + agé de 54 ans
- +148. Ci Git J.M.B. St.Gemme
 + né a Kaskaskia le 24d'août1780
 + mort le 4thFevrier1852
 + agé de 71,5mois,et 9jours
- +149. Ci Git Marie Therese St.Gemme
 + née de M-----t dit LaSoudrais
 + a Kaskaskia, Illinois
 + morte à Ste. Genevieve le 30Avril
 + 1807
 + agée de 56 ans
- +150. Ci Git
 + Jean Baptiste St.Gemme Beauvais
 + né à Kaskaskia le 21Mars1746
 + mort a Ste. Genevieve le 9Juillet
 + 1833
 + agé de 87 ans
 +
 +

151. Ci Git Raphael St. Gemme
ne a Kaskaskia le 13 Mars 1771
mort a Ste. Genevieve le -- Mars 1844
agé de 73 ans
152. Adolph Boverie
son of John L. & Adelaide R. Boverie
born - July 2, 1875
died - Jan 22, 1876
153. Addie R.
wife of John L. Boverie
born - June 26, 1853
died - April 12, 1879
154. Sacred to the memory of
Augustus E. St. Gemme
born - June 24, 18--
died - Dec 21, 18--
aged - 31 yrs, 5m, 27d
155. In memory of
Cirille Charles Gregoire
born at the Bealer near Valence,
departement of Drome, France
on the 13th day of January A.D. 1758
departed this life on the 16th
day of December A.D. 1832
and of
Mary Meunier his wife
born in Philadelphia A.D. 1768
departed this life on the 2nd day
of December A.D. 1827
one generation passeth away
and another cometh,
but the earch standeth forever.
156. Sacred to the memory of
Charles Francis
son of Francis & Mary Gregoire
born on the 3rd of March, 1842
died on the 8th of August, 1852
157. Ci Git Auguste St. Gemme
né le 23 Avrill 1791
mort le 23 Mars 1862
agé 70 ans, 11 mois
repose en pace
158. Sophie P.
infant dau. of L.C. & Augustine Menard
died - July 31, 1850
aged - 9 mos, 22 ds
159. Sacred to the memory of
William C.E. Oliver
son fo W.C. & E.L. Oliver
who departed this life in his third
YEAR
August 25, 1845
- +160. -----
+ -----
+ Jacob Roth
+ Geb. - 7 September 1819
+ ----- 1857
+ -----
+ -----
- +161. In memory of Martin Sweek
+ born at Brook County, Va
+ died - April 25, 1849
+ aged - 50 years
+ Caroline Sweek
+ consort Martin Sweek
+ born in England in 1804
+ died - May 2nd, 1849
+ aged - 45 years
+ The above named persons died of
+ cholera leaving a family of 12
+ children.
- +162. A la memoire de
+ Marie Diana LeClere
+ epouse de M.B. Menard
+ morte en mer le 14 May 1833
+ agée de 22 ans, 12 jours
+ Emilie
+ notre petite fille
+ décédée 30 Mars 1833
+ agée de 10 jours
+ repose sous cette pierre
- +163. ici repose
+ les enfants d'Auguste et de
+ Désilé St. Gemme
+ Marie A. St. Gemme
+ morte le 21 de mai 1842
+ agée de quatre ans
+ Claire M. St. Gemme
+ morte le 23 de mai 1842
+ agée de vingt-deux mois
+ Me ont laisser des regrets plus
+ durable --- le membre qui les
+ ----- et le ----- de leurs
+ lendres caresse ----- leur j-----
+ dans nos coeurs.
+ Le ----- de dieu est pour ----- us
+ qui leur --essemblent.
- +164. ici repose l'enfant d'Auguste et
+ de Désilé St. Gemme
+ M.S. Philoméne St. Gemme
+ morte le -- Novembre 1846
+ agée de -- ans et 2 mois
- +165. In memory of our brother
+ Isaac Guilloz
+

- 166.our father
 Anthony Huck
 died-Apr22,1881
 aged-69yrs,1mo,25d
- 167.Emaline Wilson
 born-August27,1839
 died-Oct6th,1869
- 168.Lora Louise Mary
 dau of -H. & Julia C. Janis
 born-Dec11,18--
 died-Feb23,1876
- 169.Bernard S. Pratte
 born-Dec25,1808
 died-Feb15,1867
- 170.Joseph G.
 son of H. & M. Blackledge
 died-Nov7,1863
 aged-5yrs,2ms,20ds
- 171.ici gite
 Marie Villars
 née le 20Mai1790
 morte le 3Mars1846
 La charité, la pieté et une vie
 innocente voici les vertues qui le
 comblent d'une gloire permanante.
- 172.ici repose
 Clement Detchemend.
 decédé le 31Janvier1856
 agé de 57 ans
 et son epouse
 Constance Detchemendy nee Janis
 decédée le 30Octobrel836
 agee de 37 ans
- 173.IHS
 ici repose les enfants d'Auguste et
 Désilé St.Gemme
 Emile F. St.Gemme
 mort le 6 de Fevrier 1829
 agé de 2 ans
 Amelie P. St.Gemme
 mort le 23 de Juillet 18-7
 agé de 18 mois
 Adolph A. St.Gemme
 mort le 2 d'aout 1829
 agé de 7 mois
- 174.Ci Git Francois LeClere
 né le 3Avrill1782
 mort le 10Mars1829
 agé de 46 ans, 11 mois, 7 jours
- 175.John B.
 son of Col. Francis & Mary A. Valle
 born-Oct29,1831
 died-Feb13,1864
- +175.(continued)
 + aged-32yrs,3ms,14ds
 + He was a dutiful son, a kind and
 + affectionate brother, had a kind
 + word and pleasant smile for all.
 + May his soul rest in peace.
- +176.To the memory of
 + Col. Francis Valle
 + born-December8th,1779
 + died-Sept14th,1849
- +177.ici gite Louis Hertich
 + né le 17Aout18--
 + mort le 26Juillet1846
- +178.In memory of Joseph Hertich
 + born-Dec30th,1775
 + died-Nov25th,1852
 + aged-76yr,10mos
 + Joseph P. Hertich
 + born-15thJanuary1817
 + died-16September1858
 + aged-4lyears and 8months
- +179.ici gite
 + Henry A. Hertich
 + né le 23Janvier1834
 + mort le 18Septembrel845
 + A peine avait - Il visité ses
 + parents lorsque Dieu l'apella à
 + lui.
- +180.Ci Git Marie Francoise Pratte
 + née Vallé
 + decédée le 17Mars1841
 + agée de 62 ans, 9 mois
 + Passans contemplez ici les -----es
 + mortels d'une bonne e-----ns l'une
 + mère tendre et fidélé amie. A
 + l'exemple de ces genereux chrétiens
 + que loue m-----nt. Elle assisté
 + les pauvres --elon ses forces sa
 + charité c--m--ie
 + un fleure sorti d'une sou---ee
 + vive et chondants se repandoit.
 + ---- son ame repose en paix.
 + ---- telle ceux qui l'enton-----
 + -----
 + Prov. 31
- +181.Here reposeseth
 + Mary Wilkinson
 + daughter of Emely S. and Walter
 + Wilkinson
 + born-30thMay1839
 + departed this life 22d November
 + 1846
 + aged-7years,7months and 22days

181. (continued)
 Sleep on Angelic one.
 Nipped in thy tender bloom
 Upon whose infant soul
 No earthly blight had come.
 Rest then my lovely babe
 Beneath this silent tomb
 Thy spirit's up above
 Reveling in God's own love.
182. Ici repose Joseph Pratte
 né le 8Decembre1774
 décédé le 3Janvier1847
183. In memory of Peter Pratte
 born-June6,1801
 died-August27,1853
184. Ci Git Marie Roussin
 née Govro
 décédée le 18Juillet1850
 l'age de 23 ans
185. Frederick Seysler August Seysler
 died-May10,1870 died-Dec18,1872
 aged-lmo,3d's aged-5yrs,6m,16d
186. Died Charles Hypolite Gregoire
 at his residence in Dubuque, Iowa
 Nov7th,1859 in the 62 year of his
 age.
 Requiescat in pace
 "mourned so universally, how uni-
 versally he must have been loved."
 by an observer
 erected by Charles Henry Joseph
 only son and hier to the memory of
 his father
187. Sacred to the memory of
 Doctor Walter Fenwick
 born-April17th,1771
 died-October--,1811
 and Zenon Fenwick
 son of Walter Fenwick and Julia T. Valle
 born-November11,1805
 died-Aprill-,1814
188. Ci Git Marie Adalie LeClere Thomure
 née 15Decembre1820
 morte 27Mars1845
 agée de 25 ans
189. Sacred to the memory of
 J. Theodore Thommur
 born-December15th,1820
 died-July17th,1849
190. Marie Hoffman
 died-April,184-
 aged--5
- +191. In memory of William Hoffman
 + -----
 + -----
 + In memory of James Hoffman
 + died-Nov22,1841
 + aged-lyear,1lmo
 + In memory of Josephine Hoffman
 + died-Oct8,1844
 + aged-2years,1lmo
- +192. In memory of Martha Bossier
 + died-Jan16,1860
 + R.I.P.
- +193. In memory of Sebastian Ziegler
 + died-July20,1861
 + age-73years
 + R.I.P.
- +194. Sacred to the memory of
 + Luzia Ziegler
 + born-Luzia Schlegel at Immeneich
 + Amt Waldshut, Duchy of Baden,
 + Germany-May23d A.D. 1792
 + died-Ste. Genevieve, Missouri-
 + December30th A.D. 1852
 + R.I.P.
- +195. Louis Joseph Delcommune
 + mort le 17Octobre1852
 + agé de 30 ans
- +196. ici repose le corps de
 + Joseph Benoist Govrau
 + décédé le 10Juin1867
 + agé de 33 ans
- +197. -elien LaRose
 + born-July15th,1820
 + died-Oct15th,1867
- +198. Here rests Louis LaRose, Sr.
 + born-Oct5,1793
 + died-Apr22,1865
- +199. In memory of Elvina Ziegler
- +200. ici repose
 + Marie Claudine Rey
 + epouse de Joseph Marie Rey
 + mort le --Sept1870
- +201. In memory of Conrad C. Ziegler
 + born at Wald-----, Germany
 + April--,1815
 + died in Ste. Genevieve, MO
 + December--,1863
 + May he rest in peace
- +202. Benjamin Bogy
 + né a Ste. Genevieve le 11May1827
 + mort le 18May1827
 + agé de 7 jours
 +

- 203.-----e Bogy
né à Ste. Genevieve --Avril18--
mort le 8Janvier-----
aged-----
204. In memory of Mary E.
dau of S.H. & L.E. Smith
born-Dec4, 1878
died-July27, 1880
205. Anstes Sargeant
died-Nov13, 1876
aged-71 years
R.I.P.
206. Carissimo nosuropuero
FebXXVIII AD. MDCCCXXXIII
visitato nos in domum suam
OctXI MDCCCXLIV
revertus est.
207. Ichabod Sargeant
born in Eath, New Hampshire
----22, 1792
departed this life on the
14thSep. 1848
aged-56 years
208. In memoriam T.S. Mathis
born-Sept17th, 1828
died-Sept6th, 1875
209. Sacred to the memory of
Mathurin Michael Amoureux
who died 26April, 1832
aged-84 years
210. Sacred to the memory of
----- Amoureux
who died 27August1845
aged-83years
211. Harriette J. Scott
died-June2, 1836
aged-37years
212. Marie Atala Flamm
born-August6th, 1851
and died-November7th, 1854
213. A la mémoire de Marie LaPorte
veuve de Louis LaPorte
née le 5Juillet1766
décédée le 12Septembre1849
agée de 83 ans
Erigé par son fils adoptif
W^r LaPorte
214. Henry Smith
died-August11, 18-6
age 33 yers, 2m, 2d
215. In memory of James Clark
died-Dec9th, 1851
aged-56years
- +216. In memory of
+ Catherine C. McClenahan
+ born-Oct24, 1838
+ and died-Nov21, 1840
- +217. In memory of Columbus Frazier
+ who was born Dec^r the 10th, 1814
+ and died May the 31st, 1834
+ aged-2lyears
- +218. In memory John McClenahan
+ born the 1-th Oct, ----
+ and died-Oct23, 1845
- +219. In memory of
+ Columbus McClenahan
+ born-Jan21, 1841
+ and died-Mar16, 1841
- +220. In memory of Wm. C. Adams
+ died-June25th, 1844
+ aged-9months and 17days
- +221. Here rests the remains of
+ Lewis F. Linn
+ the Model Senator of Missouri
+ born-Nov5, 1795
+ died-Oct3, 1843
+ This monument was gratefully
+ erected to the memory of Dr. Lewis
+ F. Linn by the Legislature of
+ Missouri.
- +222. E.A.R. Linn
+ born-March15, 1800
+ died-September3, 1861
- +223. Sacred to the memory of
+ Antoine Janis
+ born at Kaskaskia, Ills.-July30,
+ 1795
+ died at his farm in Ste. Genevieve
+ Co., MO-July17, 1861
+ aged-65yrs, 11mo., 17ds
+ This tomb was erected by his
+ affectionate wife Felicite Janis
+ née Bogy
- +224. Infant dau of
+ Felix H. & Julia G. Janis
+ died-Oct-----
- +225. In memory of Felix Janis
+ born-Nov21, 1810
+ died-Sep9, 1855
- +226. Sacred to the memory of
+ Henry L. Janis
+ born in Fredericktown, Madison
+ Co., MO-Aug18, 1830
+ died-Dec11, 1856
+

227. Henry Janis
born in Ste. Genevieve, MO
Sep14, 1808
died-Sep1, 1872
Blessed are the pure in heart for
they shall see God.
228. Emma Rozier
1862-1879
229. Our beloved son Joseph Rozier
born-Nov10, 1844
died-Sept8, 1864
The Lord gave, and the Lord hath
taken away, blessed be the the name
of the Lord.
JOB i. 21
Requiescat in pace.
Amen.
230. In memory of Francis B.
son of Francis & Zoe Rozier
born-June28, 1841
died-Apl. 16, 1855
231. Edouard Rozier
né le 26Fevril1852
décédé le 9Fevril1853
Enfant de Francois et Zoe Rozier
232. C. Odile
Née le 1-----
Morte le -----1---
233. Francis Janis Godfrey F. Janis
born-15April-----born-2Sept1847
died-22April1851died-8Sept1848
aged-7days aged-1year and 6days+
Christine Janis
born-6March-----
died-3Octol850
aged-6months and 27days
children of Felix & Mary A. Janis
234. Infant dau of
O.D. & Louise Harris
died-Jan27, 1864
235. died on the 13thSeptember1851
Mary Benjamin
daughter of Benjamin & Emily Shaw
aged two years & four months
236. Here reposes Mary Zoe Janis
infant daughter of Felix and Mary
A. Janis
born-September26th, 1842
died-October16th, 1848
- +237. Our Father
+ Jean Ferdinand Rozier
+ born in Nantes, France-Nov9, 1777
+ died-Jan1, 1864
+ An affectionate husband, a kind
+ and loving father, a true and
+ faithful friend and Christian.
+ Requiescat in pace
- +238. E.A. Rozier
+ born-April17, 1833
+ died-October16, 1858
- +239. Constance Rozier
+ born-Oct8, 1795
+ died-Aug24, 1878
+ aged-82yrs, 11mons, 16d
- +240. James L. Day
+ died-May11, 1852
+ aged-42years
+ Percillia Day
+ died-Oct5, 1862
+ aged-58years
- +241. John Scott
+ born in Hanover Co., VA-May18, 1782
+ died at Ste. Genevieve, MO-
+ June9, 1861
+ aged-79yrs, 2lds
- +242. In memory of Andrew Scott
+ died-Jan10th, 1831
+ aged-83years
+ Elisabeth Scott
+ consort of Andrew Scott
+ died-Junellth, 1827
+ aged-76years
+ Catherine E. Scott
+ consort of John Scott
+ died-Dec24th, 1813
+ Elisabeth A. Scott
+ daughter of John & Catherine E.
+ Scott
+ born-Dec8th, 1811
+ died-1816
+ aged-5years
- +243. Ci Git Francois Charles Janis
+ né le 4Novembre1820
+ décédé le 21Janvier1840
+ âgé de 19 ans
- +244. Ci Git Francois Janis
+ né le 3Avrill1761
+ décédé le 20Octobre1832
- +245. Ci Git Pelagie Janis née Bienvenu
+ née le 24Juin1769
+ décédée le 1-Septembre1832
+

246. Firmin Rozier
né le 28Septembre1845
décédé le 10 de Novembre 1845
Marie Louise Rozier
née le 11 d'Août1847
décédé le 28Fevrier1848
enfants de Francois et Zoe Rozier
247. Ci Git Marie Louise Vallé née Janis
née le 12Juin1798
décédé le 4Mail827
248. Ci Git Henri J.B. Vallé
fils de J.B. Valle et ed Pelagie
Janis
né le 29Avrill1830
décédé le 19Nov1833
249. -----ing
Jan30,1-22
Feb4,19--
250. Moses Govereau
died-Oct12,1877
aged-about 42years
251. Catharine
wife of John Dallas
died-Mar30,1876
aged-25years
also their daughter
died-Oct28,1875
aged-2yrs,2mo,10d
252. ----- Huck
died-Oct4,1874
aged-19yrs,10mo's
also Joseph Huck
aged-7weeks, 3days
253. Vital Beauvais
décédé le 17Novembre
agé de 77 ans
Felecite Beauvais
décédée le 5Mars
agée de 86 ans
par leur -----
Catherine -----
254. Pelagie Valle
née Janis le 10Septembre1804
décédé le 15Janvier1848
255. Ci Git Jean Baptiste Valle
né à Ste. G. le 23Septembre1829
décédé le 26Janvier1897
256. Ci Git Louis Vallé
né à Ste. Genevieve le 27May1789
décédé le 24Septembre1833
- +257. Ici repose
+ Jean B. Vallé
+ décédé le 3Août1849
+ age de 89 ans
+ et son epouse Jeanne Vallé
+ née Barbeau
+ décédée le 28Mail842
+ agée de 82 ans
+ Ils aimerent leurs sembloibles.
- +258. In memory of Francois B.Valle
+ born-Sept18,1785
+ died-July30,1851
+ aged-65yrs,10mo,12ds
- +259. Louis Felix Vallé
+ né le 22Decembre1823
+ décédé le 14Juillet1857
- +260. Odile Pratte
+ wife of Felix Valle
+ died-Aug16,1894
+ aged-89yrs,7mo,22d
- +261. Sacred to the memory of
+ Mary Ann Bisch
+ born-3dMay,1805
+ died-20thMay,1826
+ aged-21years, 17days
+ Faith in her God, she welcomed
+ death. A sweet release from pain,
+ and gently yielding up her breath,
+ she died to live again.
- +262. Sacred to the memory of
+ Albert Bisch
+ a native of the city of Frankenthal,
+ Germany
+ born-12thSeptember1779
+ died-30thJanuary1845
+ aged-64years, 4months, 18days
+ That man no guards or weapons needs,
+ whose heart the blood of Jesus knows
+ But safe may pass, if duty leads,
+ through burning sands or mountain
+ snows.
- +263. Sacred to the memory of
+ Hannh Bisch
+ relict of Albert Bisch Sen^r
+ who departed this life the 14th
+ March,1849
+ aged sixty-two years
+ The soul its earthly bonds has
+ riven.
+ She treads the paths by Angels God.
+ Why mourn to let her pass to heaven,
+ Why greive to give her back to God.
+

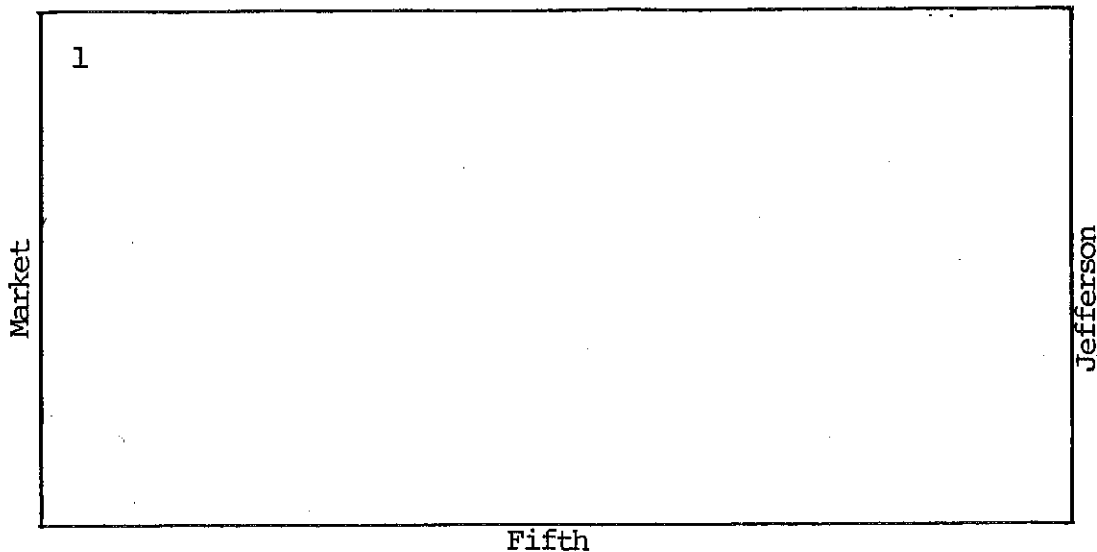

Because of the irregularity in the placement of the tombstones in this cemetery, it was not possible for us to make an accurate map of it. The stones were numbered in approximate rows starting in the southwest corner as shown above. The rows were numbered left-to-right and right-to-left alternately moving toward Fifth Street with each successive row. Thus the higher the number the farther east the stone can be found.

1. A la memoire de Francois LaVallée
premier commandant post Ste. Geneviève
pour sa majesté Catholique
né-Beauport, Canada-1716
décédé-Ste. Geneviève-1783
Pierre Gibault, Curé
Francois Vallé
commandant civil et militaire post
Ste. Geneviève 1796-1804
né-1758 décédé-1804
Jean Baptiste Vallé
dernier commandant post Ste. Geneviève
Mars 10, 1804-Octobre 10, 1804
né-1760 décédé-1849
dédié par Jules F. Vallé
1934
2. Sacred to the memory of
François LaVallée
born-Beauport, CA.
Jan 2, 1716-Sept 23, 1783
commandant post Ste. Geneviève
1770-1783
François Vallé
Jan 10, 1758-March 6, 1804
commandant post Ste. Geneviève
1789-1804
R.I.P.
3. Sacred to the memory of
Rev. Francis X. Weiss
born-July 15, 1821 at Schleltstadt,
Alsace
ordained a priest-April 29, 1848
died-March 3, 1901
R.I.P.
How beautiful upon the mountains are
the feet of him that bringeth good
tidings, and that preacheth peace.
Of him that showeth forth good, that
preacheth salvation.
Is. C.L, 2V, 7
4. Ci Git Francois Corset
ancien chantre de cette eglise
décédé le XV de Janvier, 1798
R.I.P.
Je chanterai eternellement les
misericordes du Seigneur.
PS. 83, V. 1
5. Ci Git le Rev. Jacques Maxwell
décédé le 28 Mail 1814
agé de 72 ans
curé de cette paroisse de 1797 à 1814
R.I.P.
5. (continued)
+ Heureux ceux qui demeurent dans Votre
+ maison Seigneur, ils Vous loueront
+ dans tous les siècles.
+ PS. 83, V. 5
6. IHS
+ Ci Git le Rev. Henri Pratte
+ né dans cette ville en 1787
+ institué curé de cette paroisse en
+ 1816
+ décédé le 1^{er} Sept^{re} 1822
+ Modèle de charité et de toutes les
+ vertus sacerdotales, si sa mort fut
+ le commencement de son bonheur dans
+ le ciel, Elle laissa sur la terre des
+ regrets plus durable que le marbre
+ qui le couvre.
+ R.I.P.
7. To the memory of the
+ Rt. Rev. Charles L. Van Tourenhout
+ born-February 22, 1863
+ died-April 25, 1947
+ who served the people and parish of
+ Ste. Genevieve for 58 years.
+ "They that instruct many to justice
+ shine as stars for all eternity."
+ Dan. XII, 3
+ Requiescat in Pace
8. In grateful memory of Felix Vallé
+ Feb 12, 1800-Oct 1, 1877
+ Odile née Pratte, his wife
+ Dec 24, 1804-Aug 16, 1894
+ Benefactors of Ste. Geneviève Church,
+ School & Convent. And in doing good
+ let us not fail, for in due time we
+ shall reap, not failing.
+ Gal. VI, 9
9. Here lies beneath the commandant's
+ pew of the original church,
+ Francois Vallé, fils
+ "Commandnat, civil et militaire
+ poste Ste. Genevieve" 1796-1804
+ born-1758 died-1804
+ and his wife, Marie Vallé
+ née Carpentier
+ R.I.P.
+ presented by Isabel Vallé Brookings
+ 1939

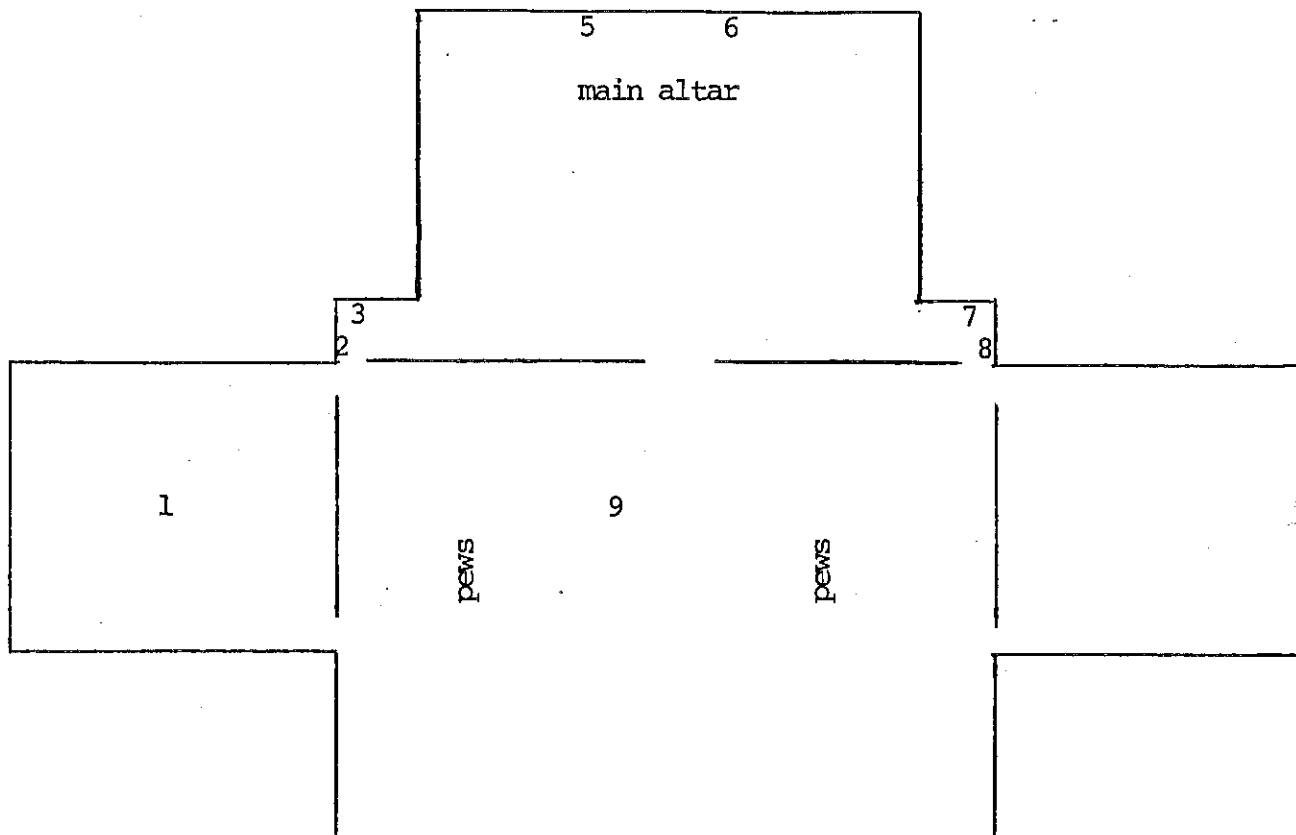

à--at, to
 age--age
 agé(e)--aged
 an--year pl--ans
 au--at
 ci--here
 corps--body
 curé--priest
 d'--(see de)
 de--of, from
 décédé(e)--died
 dédié--dedicated
 dernier--last
 en--in, at
 enfants--child
 pl--enfants
 épouse--spouse
 est mort--died
 et--and
 famille--family
 femme--wife
 fille--daughter
 fils--son
 git(e)--lies
 ici--here
 jour--day pl--jours
 l'--(see le)
 la--the
 le--the
 (page19)N'ayant pas des parant ici je sollicite les prieres de passants.
 Not having relatives here I sollicite the prayers of passer-bys.
 (page20)----- le mort qui se sont -----.
 ----- the death which was -----.
 (page22)Jamais mari et pere fut plus regretté. Par sa femme et ses enfants. L'une et l'autre conserront pour toujours sa mémoire.
 Never was a husband and father more grieved by his wife and children. All keeping forever his memory.
 (page22&23)The inscription on stones 102 & 103 was mistakingly thought to be two separate inscriptions. It should read as follows.
 Laissez venir à moi les petits enfans, et ne les empêchez point; Car c'est a leurs semblables que le Royaume de Dieu appartient.
 Let the little children come to me. Do not shut them off. The Kingdom of God belongs to such as these.

leur--their
 mémoire--memory
 mer--sea
 mois--month
 mort(e)--died
 né(e)--born
 notre--our
 paix--peace
 par--by
 petit(e)--small
 quatre--four
 repose--rests
 veuve--widow
 vingt-deux--22

janvier-January
 février-February
 mars-March
 avril-April
 mai-May
 juin-June
 juillet-July
 août-August
 septembre-September
 octobre-October
 novembre-November
 décembre-december

FRENCH (page24)Cette pierre humble tribut
 + de respect et de veneration pour sa
 + memoire lui est consacrée par ses
 + petits fils.
 + This humble stone, tribute to the
 + respect and veneration for his
 + memory, is dedicated by his grand-
 + sons.
 + (page25)repose sous cette pierre
 + rest beneath this stone
 + (page26)La charité, la pieté et une
 + vie innocente voici les virtues qui
 + le combent d'une gloire permanante.
 + Charity, piety and an innocent life,
 + here are the virtues which make a
 + permanent glory.
 + (page26)Passans contemplez ici les
 + -----es mortels d'une bonne e--ms
 + l'une mere tendre et fidele amie. A
 + l'exemple de ces genereux chretiens
 + que loue m-----nt. Elle assiste les
 + pauvres ---elon ses forces sa charite
 + c--m--ie.
 + un fleure sorti d'une sou---ee vive et
 + chondants se repandoit.
 + ---- son ame repose en paix.
 + ----telle ceux qui l'enton.
 + Passer-bys gaze upon here the mortel
 + ----- of a good -----, a tender
 + mother, and faithful friend. To the
 + example of those generous Christians
 + that praise -----. She helped the
 + poor ----- her strength and charity.
 + A flower gone from one ----- to live
 + and ----- go out.
 + ----- her soul rest in peace.
 + ----- like those which put it rest.
 + (page28)Erigé par son fils adoptif.
 + Erected by her adopted son.
 + (page30)Ils aimerent leurs sembloibles.
 + The loved their fellow-creatures.
 + (page33)premier commandant post Ste.
 + Geneviève pour sa majesté Catholique
 + First commandant Ste. Genevieve post
 + for his Catholic majesty.
 + (page33)ancien chantre de cette eglise
 + Je chanterai eternellement les
 + misericordes du Seigneur.
 + former singer of this church
 + I will sing the mercies of the Lord
 + eternally.

ACKMAN, Marie A.	10 +	BAUMGARINER, Ida S.	8 +	BOGY, Marie	22
Wilson H.	10 +	John	14 +	BOND, Charles T.	4
ACUFF, Flora V.	2 +	Marie Eva	14 +	Dora	4
Patrick H.	2 +	BAW, Luther W.	11 +	Dorris	4
ADAMS, Catharine	23 +	BEASLEY, Emma L.	2 +	BONNOAU, Maire L.	20
George J.	2 +	John H.	2 +	BOSSIER, Martha	27
Ruby E.	2 +	Joseph E.	2 +	BOVERIE, A.M.	24
William	23 +	BEAUVAIS, Charles	12 +	Adelaide R.	25
William C.	28 +	Felicite	30 +	Adolph	25
AGARAND, Frieda K.	7 +	Jean Baptiste	+	Antoinette	24
Joseph A. Sr.	7 +	St. Gemme	24 +	John L.	25
AKINS, Linda Lee	5 +	Marie	22 +	Joseph Chable	24
ALBRIGHT, Annie L.	1 +	Vital	30 +	BOYER, Cornelia	18
Clyde T.	1 +	BEBION, Anna	18 +	Donna Marie	12
ALLEN, Geraldine	15 +	Gottlob	18 +	Elie G.	18
AMOUREUX, Amable	23 +	BELTRAMI, Antoine	20, 21 +	Ely	18
Mathurin	+	Emily	21 +	Ely	18
Michael	28 +	Joseph	21 +	Felix G.	11
ANDERSON, Andrew	18 +	Mary Agnes	21 +	George Levie	23
Edward	18 +	Mary Felicity	21 +	Mary Ann	9
Ray R.	9 +	BENNETT, Herbert	6 +	Norene	11
ANDRÉ, Pölline	23 +	Oscar	6 +	Proste	9
ANTHONY, D.W.	6 +	BEQUETTE, Emelie	22 +	BRADY, Thomas J.	20
M.V.	6 +	J.B.	23 +	BRAKE, Charles A.	11
Mildred A.	6 +	BERRY, Hiram	12 +	Dorothy B.	12
ARNOLD, James F.	11 +	BEYATTE, Harry	4 +	Harold G.	12
Louie F.	11 +	BIEL, Amelia Sophia	16 +	Nancy A.	12
AUBUCHON, Henry August	18 +	Charles	14 +	Silas W.	12
AYERS, Mary Lou	8 +	G.H.	16 +	Tempey L.	11
Orville T.	8 +	Sophie	14 +	BRINKMAN, Ivan Paul	4
BADEAU, Caroline	23 +	BIENVENU, Pelagie	29 +	Margaret Jane	4
BALLINGER, Frances C.	8 +	BISCH, Albert Jr.	31 +	BROOKINGS, Isabel	33
Homer J.	8 +	Albert Sr.	30 +	BROOKS, Elizabeth	23
BALRIDGE, Dorothy M.	8 +	Charles	31 +	John	23
BARBEAU, -----	31 +	Hannh	30 +	BROWN, Bessie	1
Jeanne	30 +	Mary A.	31 +	Bessie M	12
BARWIG, Edna M.	6 +	Mary Ann	30 +	Harold H.	1
John H.	6 +	BLACKLEDGE, H.	26 +	Herbert J.	12
BASLER, Donna Marie	12 +	Joseph G.	26 +	John W.	1
BAUER, Barbara A.	15, 16, 17 +	M.	26 +	Josie	1
Elisabeth	16 +	BLOOM, Paul B.	8 +	Karen R.	10
George A.	15, 16, 17 +	BLYTHE, Elmer Lee Jr.	9 +	Leatha M.	10
George W.	14 +	Opal L.	9 +	Leonard E.	10
Georg H.	16 +	BOATRIGT, William Fred	9 +	Lewis B.	1
Henry	14, 15 +	BOLAND, Eula M.	10 +	Louise	1
Katharina	17 +	Gussie J.	10, 11 +	Mary E.	1
Lily B.	14, 15 +	Randolph Lee	12 +	Rosa Ann	1
Luther Bradford	15 +	Zella Ann	12 +	Roy J.	12
Thomas	14 +	BOGY, -----	28 +	BRUGERE, Adelaide	20
BAUM, Caroline	21 +	Benjamin	27 +	Anthony	20
Hedwig	22 +	John L.	24 +	BRUIDGRE, Bessie	3
BAUMGARINER, Arthur J.	8 +	John L.	24 +	BRUMFIELD, Chester A.	10
August	14 +	Joseph	22 +	Mabel G.	10

BUCKHOLTZ, Edgar A.	7	+CULVER, A.A.	20	+FINLEY, Mary Ann	11
BURGERI, Rosean	22	+ Amos	20	+ Roy E.	11,12
Teresa	22	+DALLAS, Catharine	30	+FISHER, Irene D.	15
BYRD, Geo. H.	8	+ John	30	+ John B.	18
Mary M.	8	+DAVIS, George H.	12	+FITZKAM, Katherine N.	11
Richard E.	2	+DA VITZ, Louise Marie	15	+ Oliver J.	11
CABRAL, Christine H.	5	+DAY, James L.	29	+FLAMM, Marie Atala	28
Christy G.	5	+ Percillia	29	+FOESTE, Albert J.	8
CAILLOT, Jean Noel	22	+DE LA FONT, Charlotte	21	+FORBES, Kenneth E.	5
Marie Rosalie	22	+ Jean		+FRAZIER, Columbus	28
CALLIOTT, Clara Emely	19	+ Baptiste	21	+ Mary	23
Odile Josephine	19	+DELCOMMUNE, Louis Joseph	27	+FREELAND, Morris	5
CAMPBELL, Louize Hannah	1	+DENLER, John	15	+GARRISON, Alvin Ralph	9
S.D.	9	+ Magdalena	15	+ Rose Bernice	9
William E.	1	+DERAMUS, Evelyn Sue	3	+GEILER, Theresia	23
CARPENTIER, Marie	33	+DEICHEMENDY, Clement	26	+GERARD, Ugenie	31
CARRON, Joseph	18	+ Constance	26	+GIBAULT, Pierre	33
CAVALIER, Caroline	23	+ L.	19	+GIBSON, Clara B.	10
CHADWELL, Alexander H.	2	+ R.	19	+ Noah E.	10
Alice E.	2	+ S.	19	+ Steven D.	10
Alice M.	2	+ Sauveur	19	+GISI, Joseph J.	4
CHALMERS, James G.	3	+DIETZFELBINGER, Isabelle		+ Rosaliee	4
CHEATAM, Lloyd J.	1	+ A.	15	+GLORE, Henan	10
CHEESEBROUGH, Anna	3	+ John B.	15	+GOAR, James	18
Evaora	3	+DOLL, George	23	+GOLD, John	18
John	3	+DORLAC, Marie Louise		+GORDON, David S.	7
CHILDS, James P.	18	+ Ortense	22	+GOVEREAU, Moses	30
CHOUTEAU, Aglaee	21	+ Pierre	22	+GOVRAU, Joseph Benoist	27
CHRISUELL, Mary	21	+DRURY, John B.	22	+GOVRO, Marie	27
CLAPSADDLE, Clare J.	5	+DUBIEL, J.	31	+GRANNEMANN, Bessie L.	1
Hazel	5	+DUFOUR, Polline	23	+ Ralph A.	1
CLARK, Ashley H.	16	+ Theophile	23	+GRASS, Irene M.	11
Irma M.	16	+DUKES, William	18	+GREGOIRE, Charles	
James	28	+DURAN, Francois	20	+ Francis	25
Leola I.	16	+EVANS, Clarence	10,11	+ Charles Henry	
Marian F.	16	+ Edith	10	+ Joseph	27
Robert M.	16	+ Rose L.	7	+ Charles	
COFFELT, Irene T.	10	+FALLERT, Colleen A.	10	+ Hypolite	27
Velvia I.	10	+FARLOW, Luella	4	+ Cirille	
CONSTANCE, M.	23	+ Thomas W.	4	+ Charles	25
CONTANCIN, John G.	23	+FARRIS, Lewis J.	12	+ Francis	25
Mary Louise C.	23	+ Frances Leoma	12	+ Mary	25
COOK, Albert	4	+FEENEY, Evelyn E.	2	+ Mary	25
COUNTS, Laura E.	9	+ Maggie	2	+GREIN, Jos.	16
CORSET, Francois	33	+ Oscar S.	2	+GRIFFARD, Charles B.	9
COX, Gary Wayne	9	+ Samuel	2	+ Erma E.	8
Joseph	18	+FENWICK, Julia	27	+ George W.	2
CRITES, Mary S.	11	+ Walter	27	+ John H.	8
Roy D.	11,12	+ Zenon	27	+ Joseph F.	8
CUDMORE, William	18	+FEVERSTON, Chester A.	4	+ Lillian	2
CULLEY, Euletia	3	+ Eva	4	+GROBE, Anna C.H.	15
James	3	+FIEG, Catherine	8	+ Annie C.	15
CULVER, A.	20	+ Lothar	8	+ Emile L.	15

GROBE, Henry J.	15 +	HETTIG, Fidel	19 +	JANIS, Lora Louise Mary	26
Virginia E.	15 +	Joseph	19 +	Marie Louise	30
Welton G.	15 +	Katharina	19 +	Mary A.	24
GROSS, Howard W. Jr.	4 +	HOFFMAN, James	27 +	Mary A.	29
GUIBOURD, J.	31 +	Josephine	27 +	Mary Zoe	29
Marie Thérèse	23 +	Marie	27 +	Pelagie	29
GUIGNON, Carmelite	22 +	William	27 +	Pelagie	30
Eliza M.	22 +	HOGAN, Jeremiah	18 +	JEFFRIES, John	18
John A.	22 +	HOLDER, Claude Jr.	10 +	JENKINS, Armel L.	12
Simon A.	22 +	Claude Sr.	10 +	Carrie	10
GUILLOZ, Catherine	14 +	Lucille	10 +	Enid M.	12
Isaac	25 +	HOLMANN, Ester E.	7 +	Eula M.	10
Mary A.	18 +	HOLST, Donald C.	6,7 +	Robert Guy	10
GUYE, Francois L.	18 +	J. Harrison	6 +	Thomas	10
H-E--LING, Glennon D.	14 +	Lillie Mae	6 +	JETT, Ray	9
HAERLING, Dorothy	15 +	HOWARD, Albert J.	1 +	Zella B.	9
HALL, Chas. H.	2 +	Clyde James	1 +	JOGGERST, Wm.	4
HAM, Darrin	11 +	John W.	1,2 +	JOHNSON, Gussie C.	1
HAMPER, David Michael	7 +	Norma L.	1,2 +	Harriet E.	1
HANLAN, Elizabeth	20 +	HUCK, Anthony	26 +	JOKERST, Alvin L.	12
HARRELL, Ethel M.	9 +	John	23 +	Charles	21
James B.	9 +	Joseph	30 +	Chs.	12
HARRIS, Louise	29 +	HUGHES	5 +	Henry	9
O.D.	29 +	F. Andrew	6 +	Joseph	8
HARTER, Barbara	3 +	HUNOLD, Anton	3 +	William	8
Olive M.	5 +	HURTZELL, Samhson	23 +	KAYLOR, Duke	12
Richard S.	5 +	HUTSON, Harry A.	4 +	Fred	12
HARTMANN, Geo. F.L.	16 +	JACCARD, P.U.	16 +	KELLER, Anna J.	17
Johanna G.	16 +	JACKSON, Horace G.	6,7 +	KEMP, Andrew J.	3
HATHAWAY, Martha C.	5 +	Louis	5 +	Minnie I.	3
Martha C.	6 +	Sallie	6 +	KEMPF, Emelie	23
Reid	6 +	JAMES, Beulah H.	3 +	Francis Anthony	24
Samuel R.	5,7 +	Caroline	4 +	M. Ema	23
HAUCK, Elsie F.	8 +	Eugene V.	3 +	KENUAM, Elmer	11
Walter E.	8 +	Joseph	4 +	Rosei Lee	11
HAUSER, Gertrud	21 +	Willie B.	4 +	KIRK, John W.	11
HEAD, Sam	18 +	JANIS, -H.	26 +	Mabel V.	11
HECK, Arnia E.	8 +	Antoine	28 +	KLEIN, Michael	21
Goldia G.	8 +	Camile	24 +	KNIESS, Bertha	10
HEHR, Maria A.	16 +	Christine	29 +	KNOBEL, John	3
HEIM, Reuben C.	8 +	Constance	26 +	KONEMANN, William P.	16
HENDERSON, Charles	31 +	Felicite	28 +	KONTZ, Baby Girl	14
Gordon	31 +	Felix	28,29 +	Robert L.	14
John	31 +	Felix H.	28 +	KRIEGER, Clarence W.	14
HENSON, Archie	3 +	Francis	29 +	Eula M.	14
Dorothy E.	9 +	Francois	29 +	KRUGER, Eleanor	5
Lonnie W.	9 +	Francois Charles	29 +	Francis S.	5
HERTER, Henry	14 +	Godfrey R.	29 +	KRUSE, Arthur	15
HERTICH, Henry A.	26 +	Henry	29 +	F.	16
Joseph	26 +	Henry L.	28 +	J.	16
Joseph P.	26 +	Jules F.	24 +	Lucy E.	15
Louis	26 +	Julia C.	26 +	Wilhelmine	16
HETTIG, Felix	19 +	Julia G.	28 +	KUEKER, Christina	14

KUEKER, Esther F.	15	+LOIDA, Rachel C.	1	+MC CARRON, Paul J.	3
Herman F.	15	+LONG, Edward G.	4	+MC CATHY, William G.	4,5
Louis	14	+ Valda A.	4	+MC CLANAHAN, Mary E.	11
KUHN, Audrey M.	7	+LORANCE, Betty L.	12	+ Robert W.	11
Tony A.	7	+ Delmas D.	12	+MC CLENAHAN, Catherine	
LA BRUYERE, George	3	+LUECKE, Anna	20	+ C.28	
LA COURSE, Charlotte	21	+ Chr.	20	+ Columbus	28
LA GRAVE, A.	18	+ H.W.	20	+ John	28
LALUMENDIERE, -----	23	+ Wilhelmine	15	+MC CULLA, E.	12
Antoine	19	+LUEKER, Alma A.	15	+MC CULLAR, Samuel E.	12
LA LUMONDIERE, Ba-----	20	+ Karl F.	15	+MC DANIEL, Lavada	5
Catherine	3	+LUCICKE, Cer.	20	+MC GARY, E.M.	4
Harold J.	4	+ W.	20	+MC GILL, Dennis	18
Harry	3	+ W.C. Emil.	20	+MC KLIN, Charlene A.	8
Mary Elzene	4	+LUNSFORD, Grace	2	+ Charles	7
LAMPMAN, Ollie D.	3	+ Louis W.	9	+ John	1
LANGENECKERT, Daniel	5	+ Noah	2	+ Rachel	1
LANKFORD, Mary L.	2	+LUTZE, August	16	+ Sylvia	8
LA PORTE, Louis	28	+LUX, Louis	15	+MC MURTY, Monroe L.	6
Marie	28	+ Mary	15	+MEAD, Andrew	8
Wl.	28	+ William	3	+ Andrew A.	8
LA ROSE, B.	31	+MAC KLIN, Bertha B.	6	+ Dorothy M.	8
Elvena	20	+ Coy J.	6	+MECKFESSEL, Ida	16
Ernest M.	7	+ Louise	6	+MEDER, H.C.	16
Felix	23	+ Martin F.	6	+MENARD, Augustine	25
Louis Sr.	27	+MADWELL, Christopher	18	+ Emilie	25
Odile	23	+MAGUYRE, Michael	18	+ L.C.	25
Ruby E.	7	+MANLY, Henry	20	+ Marie Diana	25
LA SOUDRAIS, M.	24	+MARCHAL, M. Josephine	19	+ M.B.	25
LA SOURCE, Marie B.	24	+MARLEN, Gerald E.	3	+ Sophie P.	25
Rosati	20	+ Harry B.	3	+MEUNIER, Mary	25
LA VALLEE, Francois	33	+ Lawrence S.	3	+MEYER, Anna	23
LEAVENWORTH, Mary B.	21	+ Nellie Voila	3	+ Janis E.	12
Ralph	21	+ Olive Mary	3	+ Mildred H.	9
LE CLERE, Francois	26	+ Roy W.	3	+MEYERS, Amanda	16
Grace I.	11	+ Thomas M.	3	+ Augusta Louisa	16
I.S.	24	+MARTIN, Arthur Earl	1	+ Chas.	16
Joseph V.	11	+ Carl C.	2	+ Christian H.	16
Lilburn R.	10	+ Chris C.	2	+ Mary Augusta	16
Marie Adalie	27	+ James E.	8	+MILLER, Andrew	7
Marie Diana	25	+ Larry P.	5	+ C. Leonard	3
Mary	24	+ Laura M.	2	+ Dellavan C.	5
Melanie	24	+ Lillian L.	2	+ Jesse B.	4,5
LE COMPTE, Hilaire	22	+ Lloyd A.	5	+ Lois L.	3
Joseph Hilaire	23	+ Mary N.	5	+ William D.	3
LE GRAND, A. Fred	9	+ William L.	1	+MONTGOMERY, John	20
A. Pearl	9	+MARTS, Michael W.	9	+MORAN, John Henry	8
LINN, E.A.R.	28	+MATHIS, T.S.	28	+MOREAU, Jean Baptiste	21
Lewis F.	28	+MAURICE, Leon	18	+ Mary	18
LITTEREST, Marilyn J.	7	+ Pierre	18	+ Peter	18
Marjorie	7	+MAXEY, Rosie	7	+MORO, John	19
Theodore G.	7	+MAXWELL, Rev. Jacques	33	+ Lucy Ann	21
LOIDA, Harry J.	1	+MC CARRON, Alvis V.	3	+ Mary	19

MORO, Peter	21 + PELATE, Percy E.	5 + ROBERTSON, Nicholas J.	2
MOSER, Louise	24 + PENBERTHY, Charles P.	3 + Ruth V.	2
Peter	24 + PERNOT, Ernestine	21 + ROSE, Eula V.	6
MOSS, C.E.	21 + PERRET, Francesca	14 + Leonard M.	6
Charles F.	21 + PETERSEN, Armella L.	2 + ROTH, Charles A.	15
Felicite B.	21 + Hedwig I.	2 + Genevieve	16
MOURICE, Clotide	23 + Henry C.	2 + Frank R.	6
MUELLER, Caroline A.	16 + PETERSON, Christoph	16 + Jacob	25
Chauncey L.	16 + Erestina	16 + Lena S.	15
Ethel J.	6 + PETREQUIN, Catherine	14 + Linda Lee	6
Ida	16 + Frederic G.	14 + Stella	7
MULLINS, Andrew W.	5 + PFEIFER, Clell R.	9 + Stella G.	6
Hilda H.	5 + Nellie E.	9 + Virginia	16
MURRAY, James	18 + PINCHOT, Pierre	16 + Wilfred J.	7
MYERS, Ethel J.	6 + PIRPLE, Effie	2 + ROTTLE, Mary Anna	20
Ray J.	6 + Neal C.	2 + ROUSSIN, Margaret	15
NAGER, Kathrina	19 + PLACETE, Marie L.	20 + Marie	27
NAUMAN, Anna M.	19 + POTIER, Joseph	19 + ROZIER, Constance	29
Catharine E.	19 + PRAT, Ma-----	22 + E.A.	29
Charles E.	19 + PRATTE, Bernard	24 + Edouard	29
NEEDHAM, Ida Bell	12 + Bernard S.	26 + Emma	29
NICKELSON, Chris	2 + Evariste F.	24 + Firmin	30
Ellen	1 + Genevieve	2 + Francis	29
Marie	1 + J.B.S.	24 + Francis B.	29
Rastus	1 + Joseph	27 + Francois	29
NOAKES, Rosie	7 + Marie Francoise	26 + Jean Ferdinand	29
NORTHCUTT, Elizabeth A.	3 + Odile	30, 33 + Joseph	29
Robert	3 + Peter	27 + Marie Louise	30
NUGENT, Charles D.	6 + Rev. Henri	33 + Zoe	29
OBERLE, Birdie Ruth	8 + PRICE, Edmond	18 + RUDLOFF, James Harley	6
Damian W.	8 + Philomena	18 + Leeman H.	6, 7
OLIVER, E.L.	25 + PRITNER, Hugh	18 + Ruth L.	8
W.C.	25 + RAABE, Frederick	20 + RUPLE, John S.	8
William C.E.	25 + Frederick	20 + Zelma I.	8
PALMER, Stacy Ann	6 + Henry	20 + SADLER, Adam	1
PARKER, Chalmer	15 + Marguereth	20 + Alvin C.	7
Sylvia A.	15 + REBER, Hazel W.	1 + Alvin W.	12
PARMER, Elmer L.	1 + RECOLÉ, Antoine	31 + Beulah M.	7
Howard W.	8 + Marquerite	31 + Felix A.	9
John	3 + REY, Joseph Marie	27 + Henry C.	1
Mamie P.	1 + Marie Claudine	27 + Jesse M.	10
Minnie B.	3 + RHINEHART, Lena I.	6 + Violet M.	9
PATTERSON, Claude R.	3 + Milton R.	6 + SAELINGER, Gertrud	21
PAYNE, Bonnie B.	10 + RIBEAULT, John	20 + STE. GEMME, Berthelew	18
Lanny R.	10 + RICKS, Agnes L.	7 + Eliza	24
Mierlan G.	9 + Virgil M.	7 + Pealgie	
Thelma I.	9 + RIGDON, Emma S.	6 + Adelaide	18
PEISH, George	22 + Francis A.	6 + ST. GEM, Gustavus	19
George	22 + RINGWALD, Mary A.	21 + Lizzie	19
Louisa	22 + ROBERT, Marie Louise	+ Steven Augustus	19
Mary	22 + Ortense	22 + ST. GEMME, Adolph A.	26
PELATE, Clarence E.	2 + ROBERTIE, Poline	31 + Amelie P.	26
Elizabeth	1 + ROBERTSON, Ethel C.	2 + Auguste	25, 26

ST. GEMME, Augustus E.	25	+ SCHULER, Anna	15	+ SKEWES, Louisa	19
Claire M.	25	+ Catherine	16	+ Marguerite	23
Désilé	25, 26	+ Charles	15	+ William	19
Emile F.	26	+ Jacob J.	16	+ SMITH, Blanche E.	10
Jean Baptiste	24	+ SCHULZE, Arthur P.	9	+ Elizabeth K.	8
J.M.B.	24	+ Mildred H.	9	+ Helen R.	5
Marie A.	25	+ SCHWEISS, Augustin	19	+ Henry	28
Marie B.	24	+ SCOTT, Andrew	29	+ John M.	18
Marie Thérèse	23	+ Catherine E.	29	+ L.E.	28
Marie Thérèse	24	+ Dellavan C.	3	+ Mary E.	28
Mary M.	19	+ Elisabeth	29	+ Melody G.	8
M.S. Philoméne	25	+ Elisabeth A.	29	+ Ralph W.	5
Raphael	25	+ Harriette J.	28	+ S.H.	28
Vital	24	+ John	29	+ SPARKMAN, Owen M.	7
SAMPLES, Beulah	4	+ William Delain	3, 4	+ Sandy M.	7
James	7	+ SEAWEL, Doyle D.	11	+ STANGE	4
Jessie	7	+ Freda V.	11	+ , Vergie L.	5
John E.	4	+ Warren Paul	11	+ William R. Sr.	5
Mamie E.	7	+ SECKINGER, Henry	24	+ STEAGALL, Delia Mae	4
Virginia Pearl	7	+ SEEBACH, Henry Theobald	21	+ Herman T.	4
SARGEANT, Anstes	28	+ SEGUIN, C. Edward	4	+ STEWART, Alice	10
Ichabod	28	+ Myrtle M.	4	+ Richard R.	10
SCAGGS, Lester R.	1	+ SEUFERT, Roudelph A.	3	+ STRETCH, Lester Sr.	5, 6
SCHAAF, Dennis W.	2	+ SEXAUER, Francesca	14	+ Mildred B.	5
Herman Sr.	12	+ Georg	14	+ Rick W.	5
Judy A.	2	+ Henry	14	+ STROMAN, Harold W.	5
Lelia F.	12	+ Hilda C.W.	15	+ Myrtle	5
Mary L.	2	+ Joseph	14, 15	+ SUCHER, Erogenia	18
Melvin R.	1	+ Joseph G.	15	+ Laurence	18
Nicholas Joseph	2	+ Katie	14, 15	+ SUEL, Virginia	16
SCHAEFER, Dorothy	15	+ Louise	14	+ SUMMERS, Russell E.	7
Fredericke	14	+ Rosa	15	+ Stella R.	7
Henry	14	+ SEYSLER, Delbert Ray	6	+ SWECK, Caroline	25
SCHILLI, Marie	21	+ E.	6	+ Martin	25
SCHIRMER, Tillie J.	14	+ J.E.	6	+ SWIFT, Bertha	10
SCHLEGEL, Luzia	27	+ Marian F.	16	+ Lucinda F.	9
SCHLOSS, Archie Lee	7	+ SEYSSLER, Edward	15	+ Robert	9
Dorothy Mae	7	+ SHAW, Benjamin	29	+ Virgel	10
SCHMIDT, William T.	7	+ Emily	29	+ Zita Marie	10
SCHMITT, Chris W.	7	+ John W.	4	+ TATE, Alfred	9
Ester E.	7	+ Mery Benjamin	29	+ Olivia E.	9
Francis B.	22	+ SHIRLEY, John C.	10	+ TAYLOR, Charles M.	3
M. Eleanora	22	+ Lena	10	+ James	4
SCHNURR, Charles H.	4, 5	+ SHOULTS, Bobby	4	+ Jane	4
Reath	4	+ Harley C.	6	+ THOMAS, Jack	5
SCHOENFELD, Albertina	16	+ Nellie L.	6	+ Peggy	5
Amelia Sophia	16	+ SIMONOT, Basil	18	+ THOMMUR, J. Theodore	27
Erestina	16	+ Francis M.	19	+ THOMUR, Emelie	22
SCHRAMM, Dorothea	20	+ SKAGGS, Loyd E.	11	+ Gabriel	21, 22
SCHREMP, Henry D.	16	+ Virginia Faye	11	+ Josephine	31
SCHROEDER, Branden Adhilt	14	+ Winifred M.	11	+ Leon	31
L.E.	14	+ SKEWES, Eliza	19	+ Odile	31
P.H.	14	+ Lewis	23	+ THOMJURE, Adèle L.	21

THOMURE, Antoine	19 +	VALLÉ, Francois	33 +	WHALEY, Luther Arle	14
Augustin Leon	31 +	Henri J.B.	30 +	WHITESIDE, Alvis R.	2
Baptiste	21 +	Isabel	33 +	Grace E.	2
Felix	18 +	Jean B.	30 +	Hazel L.	2
Josephine	24 +	Jean Baptiste	33 +	Michael E.	14
Louise	24 +	Jeanne	30 +	Roy Eugene	2
Marie Adalie	27 +	John B.	19 +	WILKINSON, Emely S.	26
Noe	20 +	Jules F.	33 +	Mary	26
Octave	18 +	Louis	30 +	Walter	26
TODISMAN, James	9 +	Louis Felix	30 +	WILLIAMS, Earl B.	1
Margaret E.	9 +	Marie	33 +	Elmer	3
TRAUTMAN, Catherine	3 +	Marie Francoise	26 +	Martha C.	1
TROLLINGER, Alfred H.	10 +	Marie Louise	30 +	Naomi	3
Doris M.	10 +	Odile	33 +	WILSON, Emaline	26
Ishmael H.	10 +	Pierre	19 +	Emil--	19
Jerry L.	10 +	Ugenie	31 +	Emili	20
TUCKER, Grace	9 +	VANDERHEYDEN, Elsie	5 +	Emily	20
Leslie R.	11, 12 +	Theodore	5 +	James Ferd.	20
Sarah E.	11 +	VAN GUNDY, Leola I.	16 +	James J.	19, 20
Thomas E.	1 +	VAN TOURENHOUT, Rev.	+	Lizy Jane	20
Virgil Ray	9 +	Charles L.	33 +	Mary	19
Virgle	9 +	VICKERS, Henry J.	1 +	WINSTON, Antoine	18
Virtle E.	9 +	Julia	1 +	Cornelia	18
TURNER, Elsie	6 +	VILARS, -----	20 +	Lewis J.	6
VAETH, Arthur J.	8 +	VILLARS, Marie	26 +	Louis J.	7
Juanita R.	8 +	VINEYARD, Emmett	6 +	Marie Louise	18
VALLE, Aglaee	21 +	Howard G.	8 +	Susuanna N.	6
Caroline A.	16 +	Pluma	6 +	WITTEMEYER, August F.	16
Charles C.	24 +	Ucal G.	12 +	WOELICH, Jane A.	9
Clara B.	24 +	VOGT, Elizabeth K.	8 +	Joseph W.	9
Col. Francis	26 +	VORST, Jennie R.	8 +	WOOD, Claude M.	5
Edwin J.	24 +	Joseph H.	8 +	Evelyn C.	5
Eliza	24 +	WADLOW, Mary E.	11 +	Hugh E.	3
Felix	30 +	Merle Walter	11, 12 +	Jessie J.	4
Francois B.	30 +	WALKER, Frances Jo	4 +	WUNDERLICH, Elisa A.	14
Frs. L.	24 +	John	4 +	William E.	14
Jean Baptiste	30 +	John H.	5 +	YARBROUGH, Elbert R.	11
John B.	26 +	Marie M.	5 +	Scott A.	6
John H.	14 +	Nann Louise	5 +	YATES, Edward	10
Julia	27 +	Phillip H.	5 +	Faye	10
L.B.	24 +	WALLACE, James A. Jr.	3 +	George W.	11, 12
Louis Joseph	24 +	Velma F.	3 +	Walter	9
Mary A.	26 +	WALLS, Clarence	5 +	YENNY, Maria A.	16
Mary L.	24 +	Susan	5 +	YOUNG, Earl P.	8
Mary M.	19 +	WARREN, Hazel M.	10 +	Rose M.	8
Neree	21 +	Roy G.	10 +	ZIEGLER, Conrad C.	27
Neree	21 +	WATSON, James W.	3 +	Elvina	27
Neree Auguste	21 +	Mary M.	3 +	J.A.	22
Odile	30 +	WEHMEYER, Clara Belle	11 +	Luzia	27
Pelagie	30 +	Edward L.	11 +	Sebastian	27
Philo E.	24 +	WEILER, Edwin	9 +	*****	
Thersa	14 +	Oleva	9 +		
Wilhelmine	15 +	WEISS, Rev. Francis X.	33 +		
VALLÉ, Felix	33 +	WHALEY, Earl	14 +		

